

CITY PARK PLAYGROUND SITE WORK

CITY OF LUCEDALE
LUCEDALE, MISSISSIPPI
GEORGE COUNTY

MAYOR

DOUG LEE

COUNCIL MEMBERS

CARRIE MOULDS.....WARD 1
JAMES REDD.....WARD 2
JASON MARTIN.....WARD 3
AL JONES.....WARD 4
LOUIS VALENTINE.....AT LARGE

INTERIM CITY CLERK

TAMMIE OLUNQUIST

UTILITIES

CITY OF LUCEDALE WATER DEPT.
MISSISSIPPI POWER COMPANY
CENTERPOINT ENERGY GAS COMPANY
SINGING RIVER ELECTRIC POWER ASSOC.
GULF SOUTH GAS COMPANY

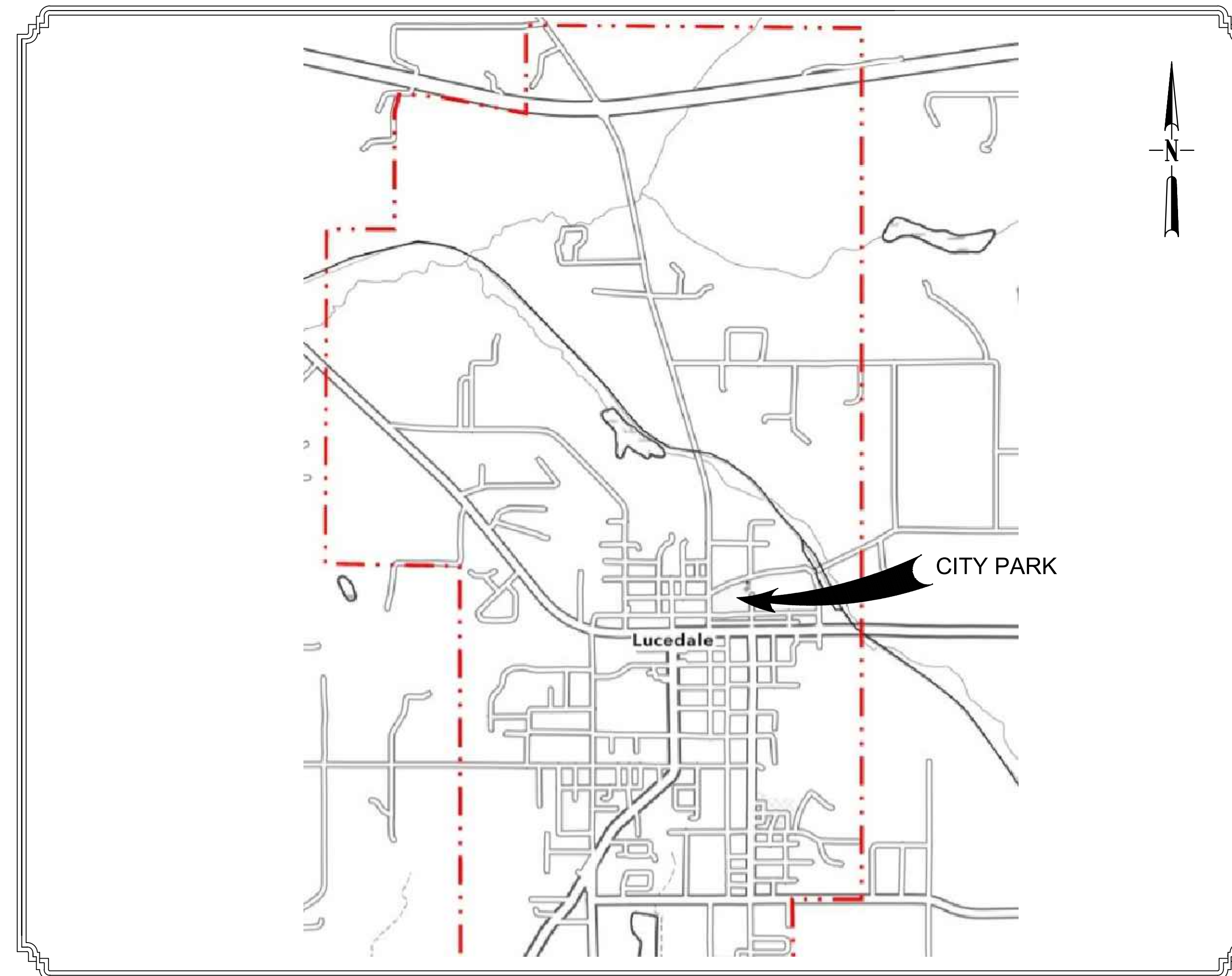

VICINITY MAP
PROJECT LOCATION

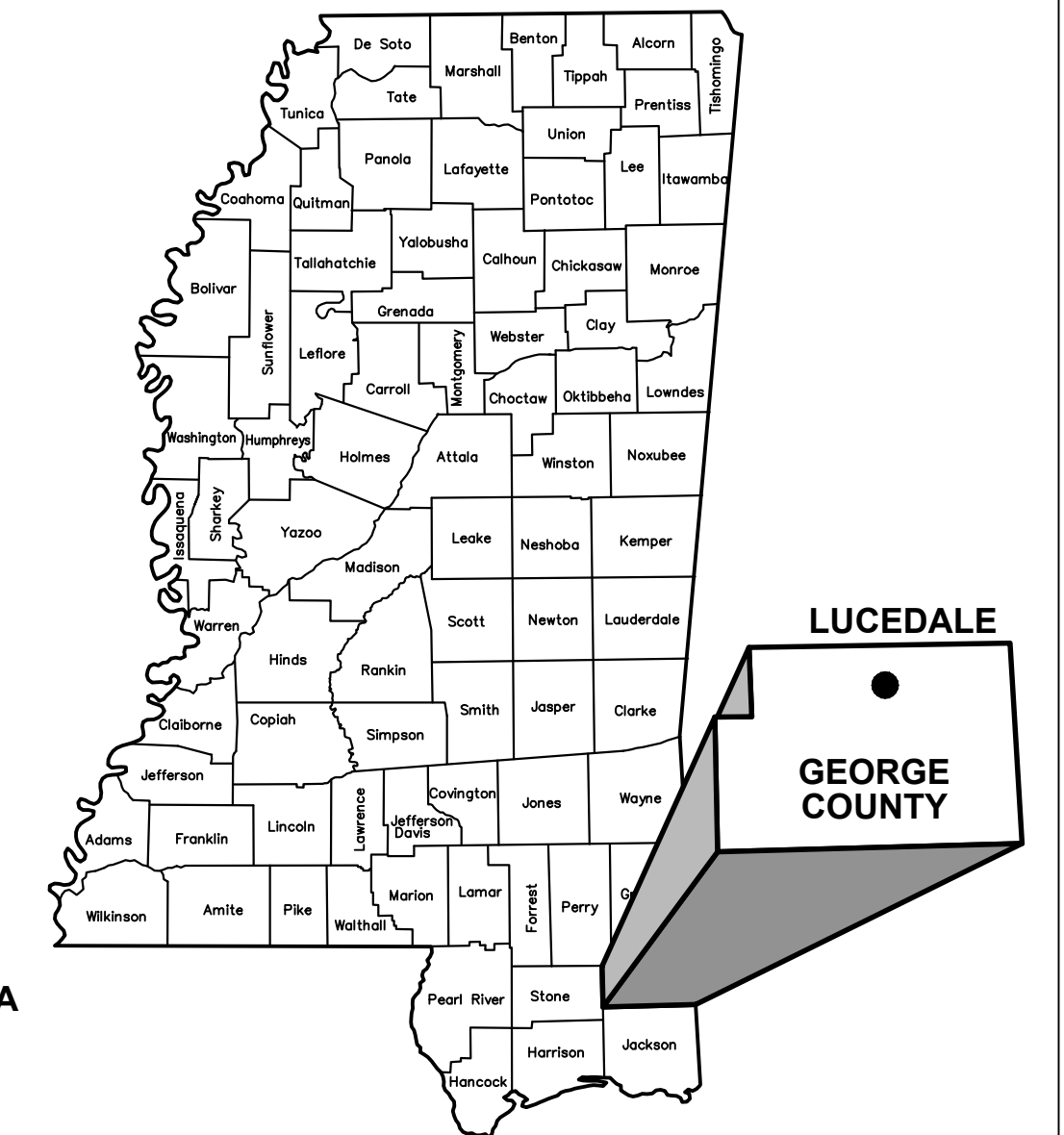

NOTE
● INDICATES PROJECT AREA

LOCATION MAP

LAT. N 30.926497018334167° LONG. W -88.58737592511913°
(APPROX. MIDDLE OF PROJECT)

CONSTRUCTION BID SET



PREPARED BY :



OLIVER PREUS, PLA, ASLA
MISSISSIPPI LICENSE NO. 653

GENERAL NOTES

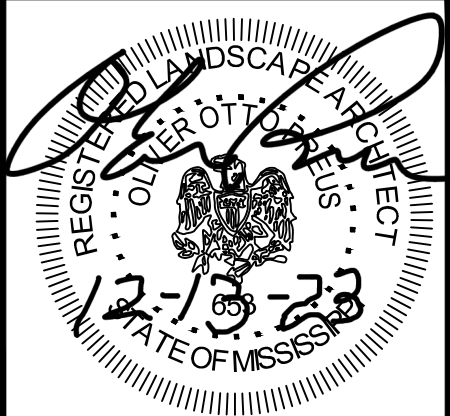
	<u>DESCRIPTION OF SHEET</u>	<u>WKG. NO.</u>	<u>SHT. NO.</u>
1. THE MISSISSIPPI STANDARD SPECIFICATIONS FOR ROAD AND BRIDGE CONSTRUCTION, 2017 EDITION, AS AMENDED, SHALL BE THE STANDARD SPECIFICATIONS FOR THE CONSTRUCTION OF THIS PROJECT UNLESS OTHERWISE INDICATED OR AMENDED IN THE SPECIAL PROVISIONS.	<u>TITLE SHEET (1)</u>		1
2. EXISTING UNDERGROUND UTILITY LINES ARE SHOWN ON THE DRAWINGS BASED UPON THE BEST INFORMATION AVAILABLE TO THE ENGINEER. THE ENGINEER CANNOT AND DOES NOT WARRANT THAT THIS INFORMATION IS COMPLETE OR ACCURATE. THE CONTRACTOR MUST COORDINATE DIRECTLY WITH THE INVOLVED UTILITY OWNERS TO HAVE UNDERGROUND UTILITY LINES FIELD LOCATED IN ADVANCE OF CONSTRUCTION.	<u>DETAILED INDEX & GENERAL NOTES (1)</u> <i>INDEX & GENERAL NOTES</i>	<i>GN-1</i>	2
3. THE CONTRACTOR IS RESPONSIBLE FOR FIELD VERIFICATION OF EXISTING GRADES AND MAKING ADJUSTMENTS AS NECESSARY WITH THE APPROVAL OF THE PROJECT ENGINEER.	<u>SITE PLAN SHEETS (5)</u> <i>EXISTING CONDITIONS</i> <i>DEMOLITION PLAN</i> <i>SITE PLAN</i> <i>DIMENSIONED SITE PLAN</i> <i>GRADING & DRAINAGE PLAN</i>	<i>EX-1</i> <i>DEMO-1</i> <i>PLN-1</i> <i>PLN-2</i> <i>PLN-3</i>	3 4 5 6 7
4. IT SHALL BE THE RESPONSIBILITY OF THE CONTRACTOR TO PROTECT EXISTING STRUCTURES SUCH AS PIPES, INLETS, APRONS, BRIDGES, ETC. FROM DAMAGE WHICH MIGHT OCCUR DURING CONSTRUCTION. EXTREME CARE SHOULD BE EXERCISED IN UNDERCUT AREAS AND THE UNDERCUT DEPTH MAY BE ADJUSTED AT CROSS DRAINS, AS DIRECTED BY THE ENGINEER. THE CONTRACTOR SHALL REPLACE OR REPAIR, AS DIRECTED BY THE ENGINEER, ANY STRUCTURES DAMAGED DURING THE LIFE OF THE CONTRACT. NO PAYMENT WILL BE MADE FOR REPLACEMENT OR REPAIR OF DAMAGED ITEMS.	<u>SPECIAL DESIGN SHEETS (3)</u> <i>TYPICAL DETAILS - SHEET 1</i> <i>TYPICAL DETAILS - SHEET 2</i> <i>DRAINAGE DETAILS - SHEET 3</i> <i>EROSION CONTROL - SHEET 1</i> <i>EROSION CONTROL - SHEET 2</i>	<i>DET-1</i> <i>DET-2</i> <i>DET-3</i> <i>ECD-3</i> <i>ECD-13</i>	8 9 10 11 12
5. WORK ON STRUCTURES FOR THIS PROJECT REQUIRES EXCAVATION IN THE IMMEDIATE VICINITY OF TRAFFIC AND ADJACENT PROPERTIES. THEREFORE, THE RISK OF A FAILURE OCCURRING DURING THE EXCAVATION REQUIRES THAT EXTREME CAUTION BE EXERCISED. IT SHALL BE THE CONTRACTOR'S RESPONSIBILITY TO PLACE WHAT BRACING, SHORING, OR GROUND SUPPORT SYSTEM THAT IS DEEMED NECESSARY TO PREVENT A FAILURE AND PROTECT THE PERSONS WORKING NEAR THE EXCAVATION, THE PUBLIC THAT MAY BE ABOVE THE EXCAVATION, OR ANY STRUCTURE ADJACENT TO THE EXCAVATION. ALL COSTS FOR ANY PROTECTIVE MEASURES INCLUDING THE MATERIALS AND LABOR FOR DESIGNING, DRAWING AND CONSTRUCTING THE FACILITY SHALL BE INCLUDED IN THE PRICE BID FOR CONTRACT ITEMS.	<u>TOTAL NUMBER OF SHEETS (12)</u>		
6. VOIDS CREATED BY THE REMOVAL OF POSTS, CONCRETE ANCHORS, FOOTINGS, ETC., SHALL BE BACKFILLED AND TAMPED IN ACCORDANCE WITH SECTION 203 OF THE MISSISSIPPI STANDARD SPECIFICATIONS FOR ROAD AND BRIDGE CONSTRUCTION (COST ABSORBED).			
7. PRIOR TO EXCAVATION AND EMBANKMENT CONSTRUCTION, ALL TOPSOIL SHALL BE STRIPPED AND STOCKPILED. AFTER COMPLETION OF EXCAVATION AND EMBANKMENT CONSTRUCTION, ALL SLOPES SHALL BE UNIFORMLY PLATED WITH THE STOCKPILED TOPSOIL. THE COST OF STRIPPING, STOCKPILING, PLACING AND SPREADING OF TOPSOIL IS TO BE INCLUDED IN OTHER ITEMS OF WORK.			
8. SOME WORK MAY BE REQUIRED OUTSIDE THE PROJECT LIMITS BEYOND THE PROJECT LIMITS. NO ADDITIONAL COMPENSATION WILL BE MADE FOR SUCH WORK EXCEPT AS PROVIDED BY SPECIFIC PAY ITEMS SHOWN ON THE PLANS.			
9. ALL RAISED OBJECTS SHALL BE PLACED A MINIMUM OF 2 FEET BEHIND THE FACE OF CURB.			
10. CONTRACTOR SHALL COORDINATE WITH THE APPROPRIATE UTILITY COMPANY IN ADVANCE OF ALL ELECTRICAL CONNECTIONS.			
11. CONTRACTOR SHALL BE RESPONSIBLE FOR MAINTAINING THROUGH AND LOCAL TRAFFIC IN ACCORDANCE WITH THE MANUAL ON UNIFORM TRAFFIC CONTROL DEVICES, CURRENT EDITION.			
12. THE CONTRACTOR SHALL PROVIDE ACCESS (INGRESS AND EGRESS) TO PARK RESTROOM AND PARKING LOT AT ALL TIMES DURING CONSTRUCTION. THE CONTRACTOR IS REQUIRED TO THE CITY OF LUCEDALE 48 HOURS IN ADVANCE OF ACCESS RESTRICTIONS.			
13. THE CONTRACTOR SHALL COORDINATE HIS WORK WITH OTHER SUB-CONTRACTOR'S TO FACILITATE TIE-INS TO OTHER CONTRACTOR'S WORK, WHERE FEASIBLE AND PRACTICABLE.			
14. THE CONTRACTOR WILL BE RESPONSIBLE FOR THE VERIFICATION, PROTECTION, AND RELOCATION OF BENCHMARKS DURING CONSTRUCTION. NO ADDITIONAL PAYMENT WILL BE MADE FOR RELOCATION OF BENCHMARKS.			
15. CONTRACTOR SHALL BE RESPONSIBLE FOR RESETTING ANY SIGNS THAT ARE IN DIRECT CONFLICT WITH CONSTRUCTION IN ACCORDANCE WITH THE TRAFFIC CONTROL PLAN AND THE MANUAL ON UNIFORM TRAFFIC CONTROL DEVICES, CURRENT EDITION (COST ABSORBED).			
16. THE CONTRACTOR SHALL BE RESPONSIBLE FOR COORDINATING WITH THE UTILITY COMPANIES IF ANY UTILITY POLES NEED TO BE SUPPORTED DURING CONSTRUCTION (COST ABSORBED).			
17. THE CONTRACTOR SHALL REPAIR FENCES, RETAINING WALLS, GATES, SODDING, LANDSCAPING, ETC. DAMAGED DURING OVERALL CONSTRUCTION (COST ABSORBED).			
18. THE EROSION CONTROL DEVICES REFERENCED IN THESE PLANS ARE A MINIMUM RESPONSIBILITY. IT IS THE RESPONSIBILITY OF THE CONTRACTOR TO INSURE THAT SILT DOES NOT LEAVE THE RIGHT OF WAY OR CONTAMINATE WATERS OF THE U.S. DURING CONSTRUCTION. THE CONTRACTOR SHALL SUBMIT AN EROSION CONTROL PLAN PRIOR TO COMMENCEMENT OF WORK AND MAINTAIN THE PLAN DURING CONSTRUCTION.			

<p>NOTICE TO DRAWING HOLDER</p> <p>NEEL-SCHAFFER, INC., HERINAFTER REFERRED TO AS THE ENGINEER HAS PREPARED AND FURNISHED THIS DRAWING TO THE OWNER FOR USE ON THIS PROJECT ONLY. THIS DRAWING SHOULD NOT BE USED ON EXTENSIONS OF THIS PROJECT OR ON ANY OTHER PROJECT. ANY REUSE OF THIS DRAWING, WITHOUT WRITTEN VERIFICATION OR ADAPTATION BY THE ENGINEER, SHALL BE AT THE REUSER'S SOLE RISK AND THE REUSER SHALL INDEMNIFY AND HOLD HARMLESS THE ENGINEER FROM ALL CLAIMS, DAMAGES, LOSSES AND EXPENSES, INCLUDING ATTORNEY'S FEES ARISING OUT OF OR RESULTING THEREFROM.</p>	<table border="1" style="width: 100%; border-collapse: collapse;"> <thead> <tr> <th colspan="3">REVISIONS</th> <th colspan="2">DRAWING INFORMATION</th> </tr> <tr> <th>NO.</th> <th>DATE</th> <th>BY</th> <th>DESCRIPTION</th> <th></th> <th></th> </tr> </thead> <tbody> <tr> <td> </td> <td> </td> <td> </td> <td> </td> <td>N-S PROJECT No.: NS.17293.001</td> <td> </td> </tr> <tr> <td> </td> <td> </td> <td> </td> <td> </td> <td>FILENAME: 17293_MASTER.DWG</td> <td> </td> </tr> <tr> <td> </td> <td> </td> <td> </td> <td> </td> <td>SCALE: NTS</td> <td> </td> </tr> <tr> <td> </td> <td> </td> <td> </td> <td> </td> <td>SURVEYED BY: BATSON & BROWN, INC.</td> <td> </td> </tr> <tr> <td> </td> <td> </td> <td> </td> <td> </td> <td>DSGN: OOP DATE: 7/2023</td> <td> </td> </tr> <tr> <td> </td> <td> </td> <td> </td> <td> </td> <td>DRWN: OOP DATE: 7/2023</td> <td> </td> </tr> <tr> <td> </td> <td> </td> <td> </td> <td> </td> <td>CHKD: RPB DATE: 12/2023</td> <td> </td> </tr> <tr> <td> </td> <td> </td> <td> </td> <td> </td> <td>QA/OC: KML DATE: 12/2023</td> <td> </td> </tr> </tbody> </table>	REVISIONS			DRAWING INFORMATION		NO.	DATE	BY	DESCRIPTION							N-S PROJECT No.: NS.17293.001						FILENAME: 17293_MASTER.DWG						SCALE: NTS						SURVEYED BY: BATSON & BROWN, INC.						DSGN: OOP DATE: 7/2023						DRWN: OOP DATE: 7/2023						CHKD: RPB DATE: 12/2023						QA/OC: KML DATE: 12/2023		<p>CITY PARK PLAYGROUND SITE WORK</p> <p>CITY OF LUCEDALE GEORGE COUNTY, MISSISSIPPI</p>			<p>GENERAL NOTES</p> <table style="width: 100%; border-collapse: collapse;"> <tr> <td style="width: 50%; border-bottom: 1px solid black;">WORKING NUMBER: GN-1</td> <td style="width: 50%; border-bottom: 1px solid black;">DRAWING NUMBER: 2</td> </tr> </table>	WORKING NUMBER: GN-1	DRAWING NUMBER: 2
REVISIONS			DRAWING INFORMATION																																																															
NO.	DATE	BY	DESCRIPTION																																																															
				N-S PROJECT No.: NS.17293.001																																																														
				FILENAME: 17293_MASTER.DWG																																																														
				SCALE: NTS																																																														
				SURVEYED BY: BATSON & BROWN, INC.																																																														
				DSGN: OOP DATE: 7/2023																																																														
				DRWN: OOP DATE: 7/2023																																																														
				CHKD: RPB DATE: 12/2023																																																														
				QA/OC: KML DATE: 12/2023																																																														
WORKING NUMBER: GN-1	DRAWING NUMBER: 2																																																																	



- TREE LEGEND:**
- -
 -
 -
 -
 -
 -
 -
 -
 -
 -
 -
 -
 -
 -
 -
 -

CONTROL POINT NAIL
 LAT = N30°55'36.2912" = GEOGRAPHIC COORDINATES IN
 LONG = W88°35'21.1564" = LATITUDE AND LONGITUDE
 N = 518966.3900 = STATE PLANE COORDINATES IN
 E = 1060796.6950 = US SURVEY FEET
 ELEVATION = 245.12
 CONVERGENCE FROM GRID NORTH TO TRUE NORTH = (0°07'32")
 COMBINED SCALE FACTOR = 0.99995671 GROUND TO GRID

- SYMBOL LEGEND:**
- -
 -
 -
 -
 -
 -
 -
 -
 -
 -

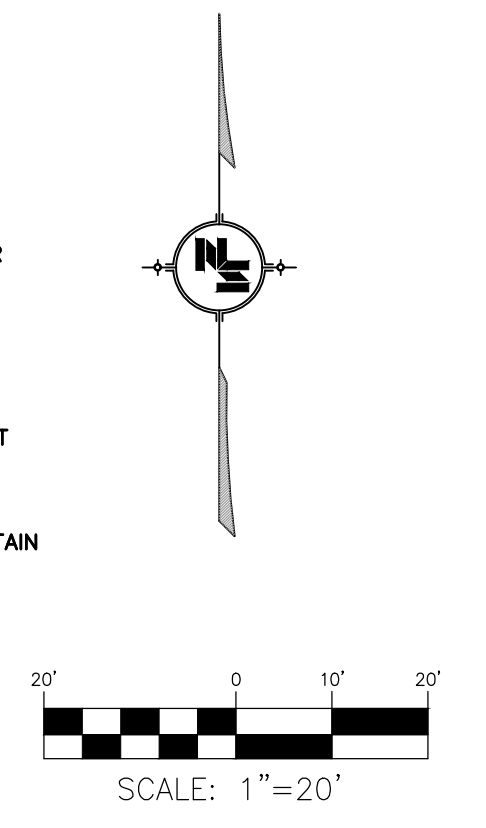

NOTICE TO DRAWING HOLDER
 NEEL-SCHAFFER, INC., HERINAFTER REFERRED TO AS THE ENGINEER HAS PREPARED AND FURNISHED THIS DRAWING TO THE OWNER FOR USE ON THIS PROJECT ONLY. THIS DRAWING SHOULD NOT BE USED ON EXTENSIONS OF THIS PROJECT OR ON ANY OTHER PROJECT. ANY REUSE OF THIS DRAWING, WITHOUT WRITTEN VERIFICATION OR ADAPTATION BY THE ENGINEER, SHALL BE AT THE REUSER'S SOLE RISK AND THE REUSER SHALL INDEMNIFY AND HOLD HARMLESS THE ENGINEER FROM ALL CLAIMS, DAMAGES, LOSSES AND EXPENSES, INCLUDING ATTORNEY'S FEES ARISING OUT OF OR RESULTING THEREFROM.

REVISIONS			DRAWING INFORMATION
NO.	DATE	BY	DESCRIPTION

**CITY PARK PLAYGROUND
 SITE WORK**

 CITY OF LUCEDALE
 GEORGE COUNTY, MISSISSIPPI

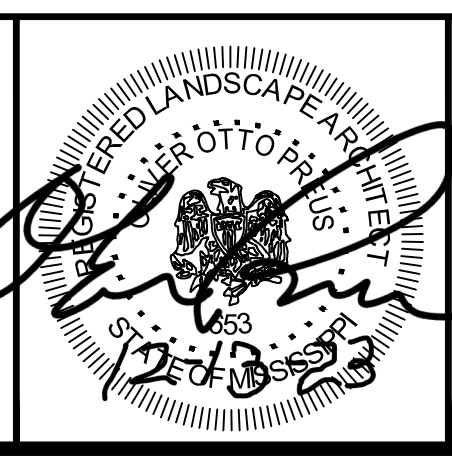

EXISTING CONDITIONS	
WORKING NUMBER: EX-1	DRAWING NUMBER: 3

DEMO LEGEND:

- REMOVED PLAY EQUIPMENT
- CONCRETE DEMO
- ASPHALT DEMO
- MASONRY DEMO (INCLUDING FOOTING)
- SITE CLEARING AND EXCAVATION
- REMOVED TREES

NOTE:
TREES TO REMAIN THAT ARE WITHIN SITE CLEARING AND EXCAVATION MUST RECEIVE TREE PROTECTION MEASURES AND SHALL NOT BE DAMAGED DURING CLEARING.

TREE LEGEND:

- = 5'-10" WILLOW OAK
- = 11'-20" WILLOW OAK
- = 21'-40" WILLOW OAK
- = 5'-10" LIVE OAK
- = 11'-20" LIVE OAK
- = 21'-30" LIVE OAK
- = 5'-10" MAGNOLIA
- = 5'-10" PINE
- = 11'-20" PINE
- = 21'-36" PINE
- = 10'-24" RED OAK
- = 24'-36" RED OAK
- = CREPE MYRTLE
- = BRADFORD PEAR
- = SHRUB/MISC.
- = 10'-20" HOLLY

CONSTRUCTION FENCING NOTES:

1. CONTRACTOR TO COORDINATE FENCE INSTALLATION WITH OVERALL CONSTRUCTION SCHEDULING. FENCING SHOWN IS FOR ILLUSTRATION ONLY. LOCATION OF FENCE IS TO BE COORDINATED WITH THE OWNER.
2. CONSTRUCTION FENCING SHALL BE INSTALLED FOR PEDESTRIAN SAFETY. ADDITIONAL AREAS MAY REQUIRE PROTECTION AS DETERMINED BY THE ENGINEER. ALL FENCING MUST BE MAINTAINED UNTIL PROJECT COMPLETION.
3. CONSTRUCTION FENCE SHALL BE PORTABLE FOR THE DURATION OF THE PROJECT. FENCE SHALL BE A MINIMUM 0.148-INCH THICK GALVANIZED-STEEL, CHAIN LINK FENCING. FENCE SHALL BE A MINIMUM 6 FEET HIGH WITH GALVANIZED STEEL PIPE POST, MINIMUM 2-3/8 INCH O.D. LINE POST, WITH 1-5/8 INCH O.D. TOP AND BOTTOM RAILS. GALVANIZED-STEEL BASES SHALL BE PROVIDED FOR POST.
4. PARKING CLOSURE SHALL BE COORDINATED WITH CITY PRIOR TO BEING CLOSED.
5. TREE PROTECTION FENCING SHALL BE ORANGE SAFETY FENCE SUPPORTED WITH T-POSTS.

REMOVAL REQUIREMENTS:

1. ALL EXISTING ITEMS IN CONFLICT WITH PROPOSED IMPROVEMENTS (REMOVAL OF DRAINAGE INLETS, REMOVAL OF DRAINAGE PIPE - ALL SIZES, CONCRETE PATHWAY/SIDEWALKS, TREES, LANDSCAPING, ASPHALT PAVING, CURB, SIGNS, BOLLARDS, FENCING, GATES, (CAP HOSE BIBS), IRRIGATION COMPONENTS (INCLUDING PVC PIPING, VALVES, METERS, ETC.), BENCHES, SIGNS ETC.)
2. SEE GENERAL NOTES RELATED TO DEMOLITION, TREE PROTECTION & TREE PROTECTION.
3. ITEMS INCIDENTAL TO REMOVAL WORK ARE INCLUDED IN PAY ITEMS AS NOTED BELOW (SAW CUTTING, LABOR, MINOR EXCAVATION, ETC.)
4. SEE GRADING SHEETS FOR GRADING LIMITS.

PAY ITEMS NOTES:

1. ALL SITE ITEMS DESCRIBED ABOVE PAID FOR UNDER SITE DEMO PAY ITEM (LUMP SUM).

CONTROL POINT: NAIL
LAT=N30°55'36.2912" = GEOGRAPHIC COORDINATES IN LONG=-W88°35'21.1564" LATITUDE AND LONGITUDE
N=518986.3900 = STATE PLANE COORDINATES IN E=-1060796.6950 US SURVEY FEET
ELEVATION = 245.12
CONVERGENCE FROM GRID NORTH TO TRUE NORTH = (0'07'32")
COMBINED SCALE FACTOR = 0.99995671 GROUND TO GRID

SYMBOL LEGEND:

- = POWER POLE
- = POWER LINE
- = HOSE BIB
- = WATER VALVE
- = WATER METER
- = CLEAN OUT
- = FIRE HYDRANT
- = WATER FOUNTAIN
- = BENCH
- = SWING SET
- = PLAY SET

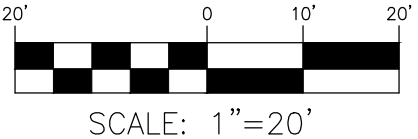

NOTICE TO DRAWING HOLDER
NEEL-SCHAFFER, INC., HERINAFTER REFERRED TO AS THE ENGINEER HAS PREPARED AND FURNISHED THIS DRAWING TO THE OWNER FOR USE ON THIS PROJECT ONLY. THIS DRAWING SHOULD NOT BE USED ON EXTENSIONS OF THIS PROJECT OR ON ANY OTHER PROJECT. ANY REUSE OF THIS DRAWING, WITHOUT WRITTEN VERIFICATION OR ADAPTATION BY THE ENGINEER, SHALL BE AT THE REUSER'S SOLE RISK AND THE REUSER SHALL INDEMNIFY AND HOLD HARMLESS THE ENGINEER FROM ALL CLAIMS, DAMAGES, LOSSES AND EXPENSES, INCLUDING ATTORNEY'S FEES ARISING OUT OF OR RESULTING THEREFROM.

REVISIONS				DRAWING INFORMATION	
NO.	DATE	BY	DESCRIPTION	N-S PROJECT NO.:	FILENAME:
				NS.17293.001	17293_MASTER.DWG
				SCALE: 1"=20'	
				SURVEYED BY: BATSON & BROWN, INC.	
				DSGN: OOP DATE: 7/2023	
				DRWN: OOP DATE: 7/2023	
				CHKD: RPB DATE: 12/2023	
				QA/QC: KML DATE: 12/2023	

**CITY PARK PLAYGROUND
SITE WORK**

CITY OF LUCEDALE
GEORGE COUNTY, MISSISSIPPI

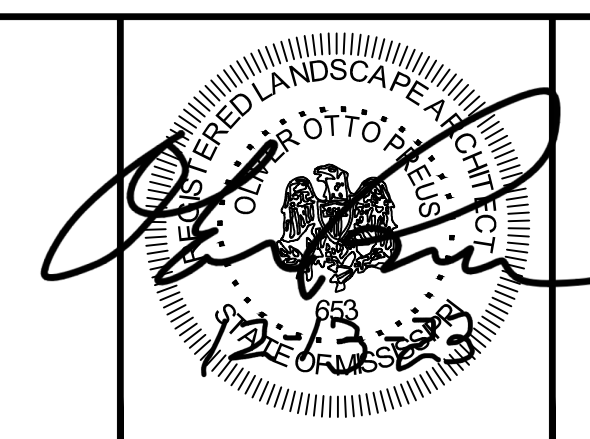

DEMOLITION PLAN	
WORKING NUMBER: DEMO-1	DRAWING NUMBER: 4

PEDESTRIAN NOTES:

1. THE SAFETY OF THE GENERAL PUBLIC WITHIN THE VICINITY OF CONSTRUCTION AREA IS EXTREMELY IMPORTANT. THE CONTRACTOR SHALL POST AND MAINTAIN, TO THE OWNER'S SATISFACTION, SIGNS THAT DIRECT THE GENERAL PUBLIC AROUND THE CONSTRUCTION AREAS USING THIS PLAN AS A MINIMUM REQUIREMENT. THE CONTRACTOR SHALL COORDINATE WITH THE OWNER PRIOR TO CONSTRUCTION.
2. THIS DRAWING IS USED TO ILLUSTRATE THE CITY'S INTENT. THE CONTRACTOR SHALL SUBMIT WITHIN 10 DAYS AFTER NOTICE OF AWARD A CONSTRUCTION SEQUENCING PLAN TO THE CITY OF LUCEDALE FOR THEIR REVIEW AND APPROVAL.
3. ADA COMPLIANT ACCESSIBLE ROUTES MUST BE MAINTAINED AT ALL TIMES THROUGHOUT CONSTRUCTION. IN ALL INSTANCES, PEDESTRIAN ACCESS ROUTES WILL NOT REQUIRE PERSONS WITH MOBILITY CONSIDERATIONS TO TAKE A DIFFERENT ROUTE FROM THAT OF A PERSON WITHOUT A MOBILITY CONSIDERATION.

NOTE:
ALL SITE FURNISHINGS INCLUDING BENCHES, TRASH RECEPTACLES, AND BOLLARDS WILL BE PART OF THE PLAY EQUIPMENT BID PACKAGE. NOT INCLUDED IN THIS BID/CONTRACT.

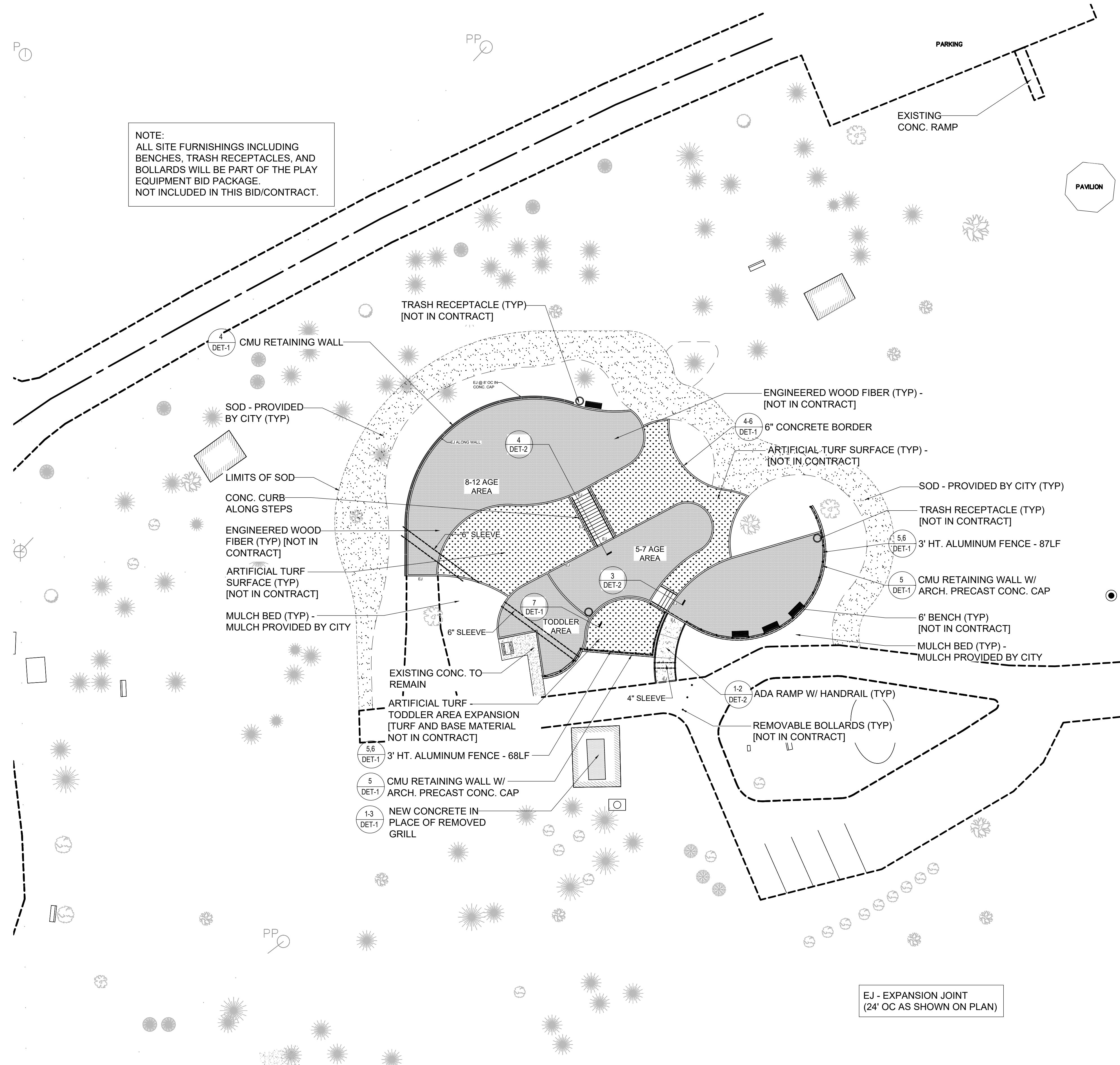

EJ - EXPANSION JOINT
(24' OC AS SHOWN ON PLAN)

NOTICE TO DRAWING HOLDER

NEEL-SCHAFFER, INC., HERINAFTER REFERRED TO AS THE ENGINEER HAS PREPARED AND FURNISHED THIS DRAWING TO THE OWNER FOR USE ON THIS PROJECT ONLY. THIS DRAWING SHOULD NOT BE USED ON EXTENSIONS OF THIS PROJECT OR ON ANY OTHER PROJECT. ANY REUSE OF THIS DRAWING, WITHOUT WRITTEN VERIFICATION OR ADAPTATION BY THE ENGINEER, SHALL BE AT THE REUSER'S SOLE RISK AND THE REUSER SHALL INDEMNIFY AND HOLD HARMLESS THE ENGINEER FROM ALL CLAIMS, DAMAGES, LOSSES AND EXPENSES, INCLUDING ATTORNEY'S FEES ARISING OUT OF OR RESULTING THEREFROM.

REVISIONS			DRAWING INFORMATION
NO.	DATE	BY	DESCRIPTION

N-S PROJECT NO.: NS.17293.001
 FILENAME: 17293_MASTER.DWG
 SCALE: 1"=20'
 SURVEYED BY: BATSON & BROWN, INC.
 DSGN: OOP DATE: 7/2023
 DRWN: OOP DATE: 7/2023
 CHKD: RPB DATE: 12/2023
 QA/QC: KML DATE: 12/2023

**CITY PARK PLAYGROUND
 SITE WORK**

 CITY OF LUCEDALE
 GEORGE COUNTY, MISSISSIPPI

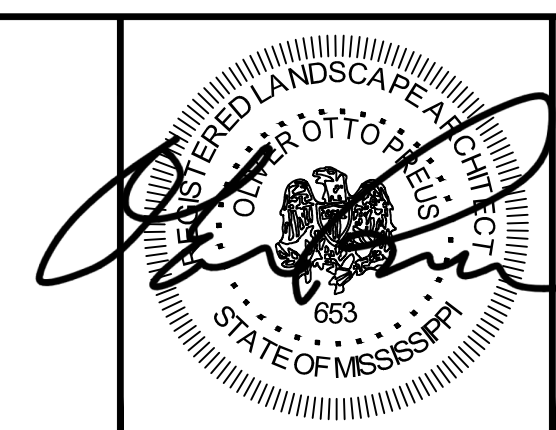

SITE PLAN	
WORKING NUMBER: PLN-1	DRAWING NUMBER: 5

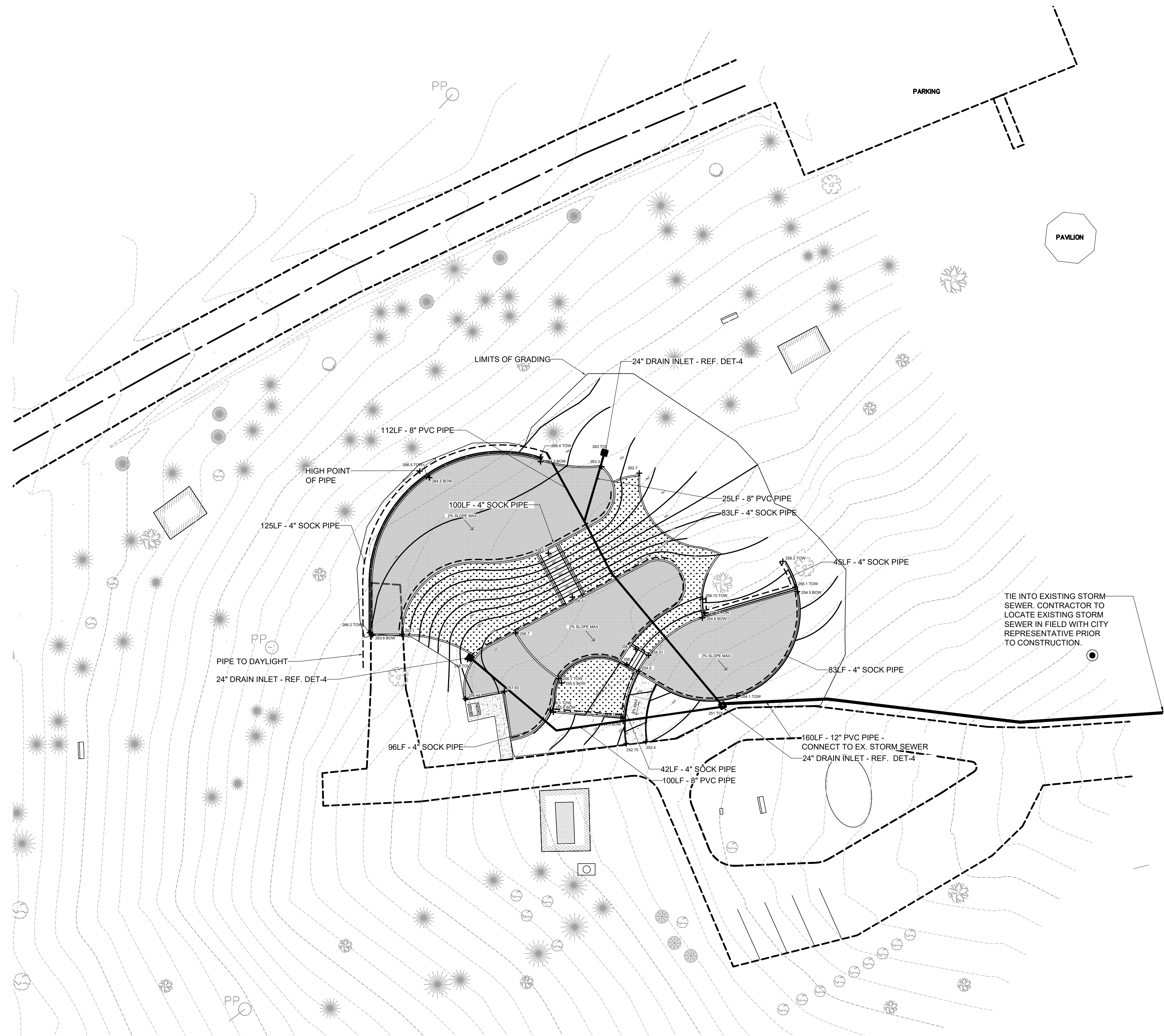

GRADING NOTES

1. REMOVE GRASSING AND STOCKPILE TOPSOIL PER GENERAL NOTE #7.
2. 6" (MIN) SANDY BORROW MATERIAL REQUIRED UNDER PLAY AREA & SIDEWALK CONNECTIONS.
3. GRADES SHOWN ON THIS SHEET ARE FINISHED GRADES. PLAY AREA SLOPES SHALL NOT EXCEED 2%.
4. SIDEWALK CONNECTIONS SHALL SLOPE TO EXISTING PAVING.
5. PLAY AREAS SHALL SLOPE TO DRAINS PER NOTE #3.
6. CARRIER PIPES SHALL BE 8" and 12" PVC PIPE - LATERAL PIPES SHALL BE 4" CORRUGATED PLASTIC PIPE - PERFORATED AND WRAPPED IN A SOCK.
7. PIPE FITTINGS AND JOINTS TO BE INCLUDED IN THE COST OF THE PIPE.
8. CONTRACTOR TO VERIFY EXISTING GRADES WITH THE LANDSCAPE ARCHITECT.
9. CONTRACTOR SHALL PROOF ROLL THE SUB-GRADE WITH THE LANDSCAPE ARCHITECT PRESENT.

UTILITY NOTES:

1. EXISTING UNDERGROUND UTILITY LINES ARE SHOWN ON THE DRAWINGS BASED UPON THE BEST INFORMATION AVAILABLE TO THE LANDSCAPE ARCHITECT. THE LANDSCAPE ARCHITECT CANNOT AND DOES NOT WARRANT THAT THIS INFORMATION IS COMPLETE OR ACCURATE. THE CONTRACTOR MUST COORDINATE DIRECTLY WITH THE INVOLVED UTILITY OWNERS TO HAVE UNDERGROUND UTILITY LINES FIELD LOCATED IN ADVANCE OF DEMOLITION AND/OR CONSTRUCTION.
2. IT SHALL BE THE CONTRACTOR'S RESPONSIBILITY TO MAINTAIN ANY AND ALL MARKINGS AS NEEDED TO PROTECT EXISTING UTILITIES. ANY DAMAGE OR INTERRUPTION OF SERVICE CAUSED BY THE CONTRACTOR'S NEGLIGENCE SHALL BE REPORTED IMMEDIATELY TO THE APPROPRIATE UTILITY COMPANY AND SHALL BE REPAIRED AND SERVICE RESTORED IN FULL COOPERATION WITH THE UTILITY COMPANY AT THE CONTRACTOR'S EXPENSE.
3. CONTRACTOR SHALL COORDINATE WITH THE CITY OF LUCEDALE ON CONNECTING THE STORM SEWER AS SHOWN BELOW. CONTRACTOR SHALL PAY ALL EXPENSES ASSOCIATED WITH THE CITY INSTALLING THE SEWER SERVICES TO THE LIMITS SHOWN BELOW.

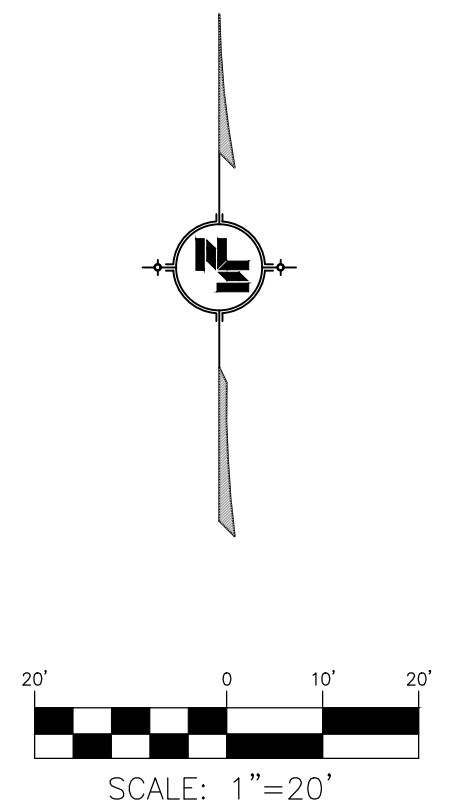

NOTICE TO DRAWING HOLDER
 NEEL-SCHAFFER, INC., HERINAFTER REFERRED TO AS THE ENGINEER HAS PREPARED AND FURNISHED THIS DRAWING TO THE OWNER FOR USE ON THIS PROJECT ONLY. THIS DRAWING SHOULD NOT BE USED ON EXTENSIONS OF THIS PROJECT OR ON ANY OTHER PROJECT. ANY REUSE OF THIS DRAWING, WITHOUT WRITTEN VERIFICATION OR ADAPTATION BY THE ENGINEER, SHALL BE AT THE REUSER'S SOLE RISK AND THE REUSER SHALL INDEMNIFY AND HOLD HARMLESS THE ENGINEER FROM ALL CLAIMS, DAMAGES, LOSSES AND EXPENSES, INCLUDING ATTORNEY'S FEES ARISING OUT OF OR RESULTING THEREFROM.

REVISIONS				DRAWING INFORMATION	
NO.	DATE	BY	DESCRIPTION		
				N-S PROJECT NO.: NS.17293.001	
				FILENAME: 17293_MASTER.DWG	
				SCALE: 1"=20'	
				SURVEYED BY: BATSON & BROWN, INC.	
				DSGN: OOP DATE: 7/2023	
				DRWN: OOP DATE: 7/2023	
				CHKD: RPB DATE: 12/2023	
				QA/QC: KML DATE: 12/2023	

**CITY PARK PLAYGROUND
 SITE WORK**

 CITY OF LUCEDALE
 GEORGE COUNTY, MISSISSIPPI

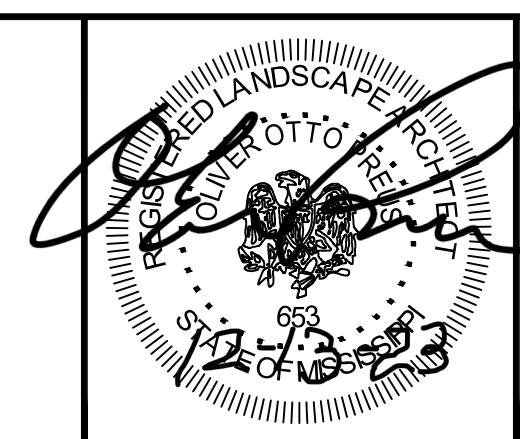

GRADING & DRAINAGE PLAN	
WORKING NUMBER: PLN-3	DRAWING NUMBER: 7

JOINT SPACING		
SIDEWALK WIDTH	CONTROL JOINT	EXPANSION JOINT
4	4	24

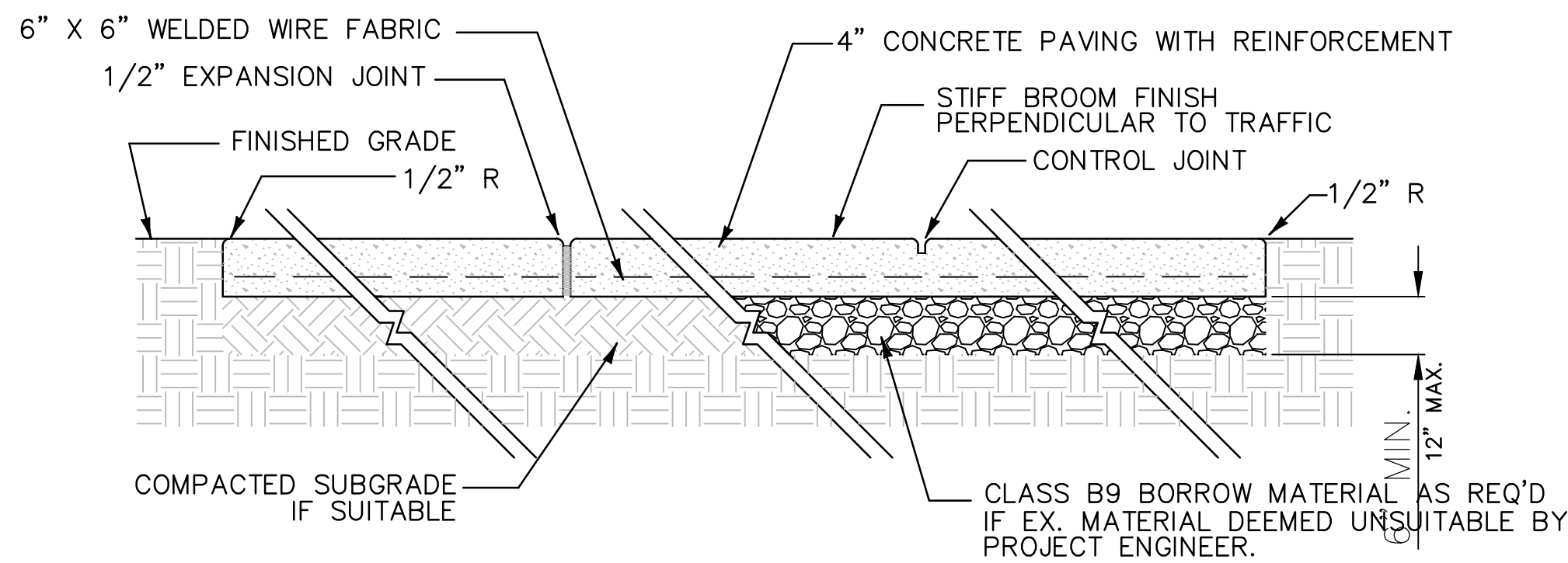

- NOTES:
- 1/2" EXPANSION JOINT CONFORMING TO ASTM D1751. TOP OF JOINT SHALL BE SEALED W/ 1/2" TAR MODIFIED URETHANE SEALANT. PLACE EXPANSION JOINT AS SHOWN IN TABLE ABOVE.
 - HAND TOOLED CONTROL JOINTS W/ 1/2" RADIUS SPACED AS SHOWN ABOVE.
 - ALL SUBGRADE SOILS FOR SIDEWALK SHALL BE COMPACTED

1. TYPICAL SIDEWALK DETAIL
NOT TO SCALE

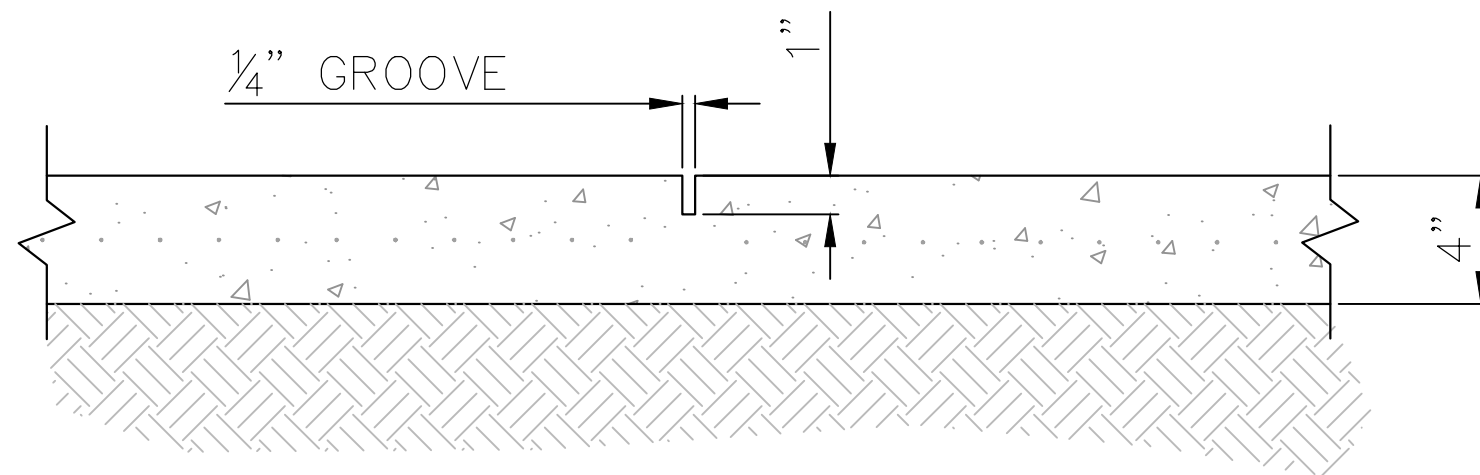

2. CONTROL JOINT DETAIL
NOT TO SCALE

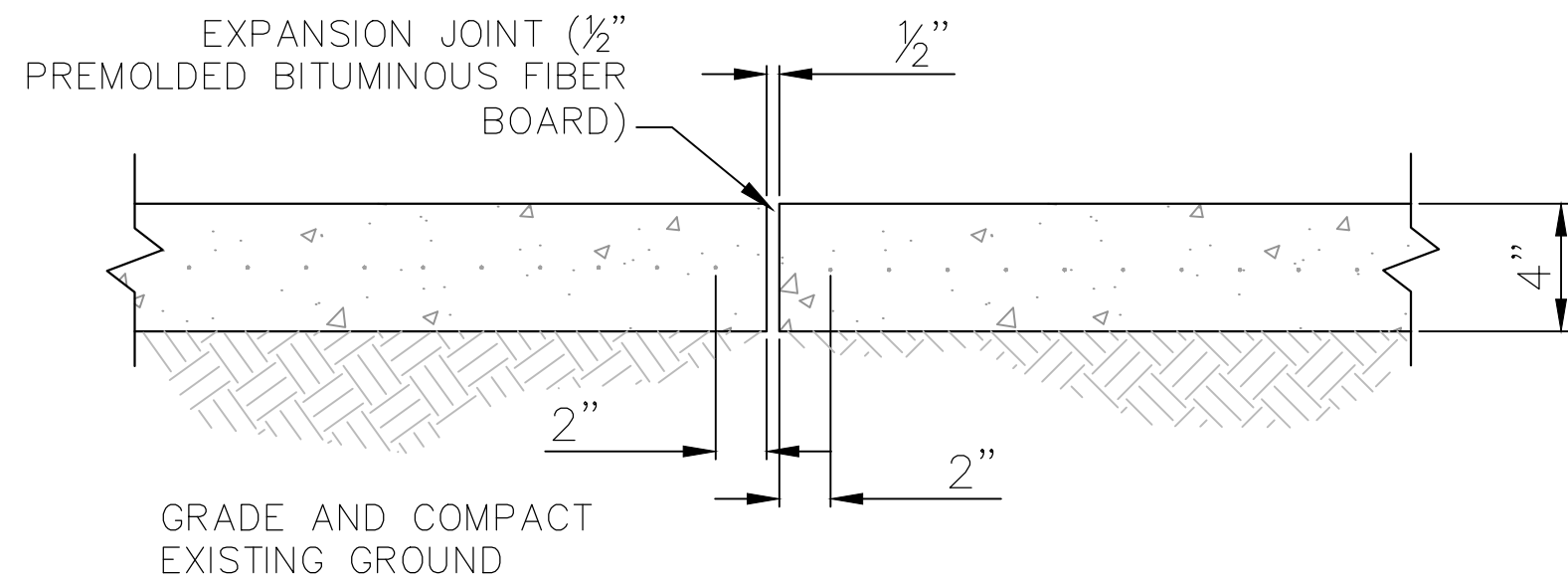

3. EXPANSION JOINT DETAIL
NOT TO SCALE

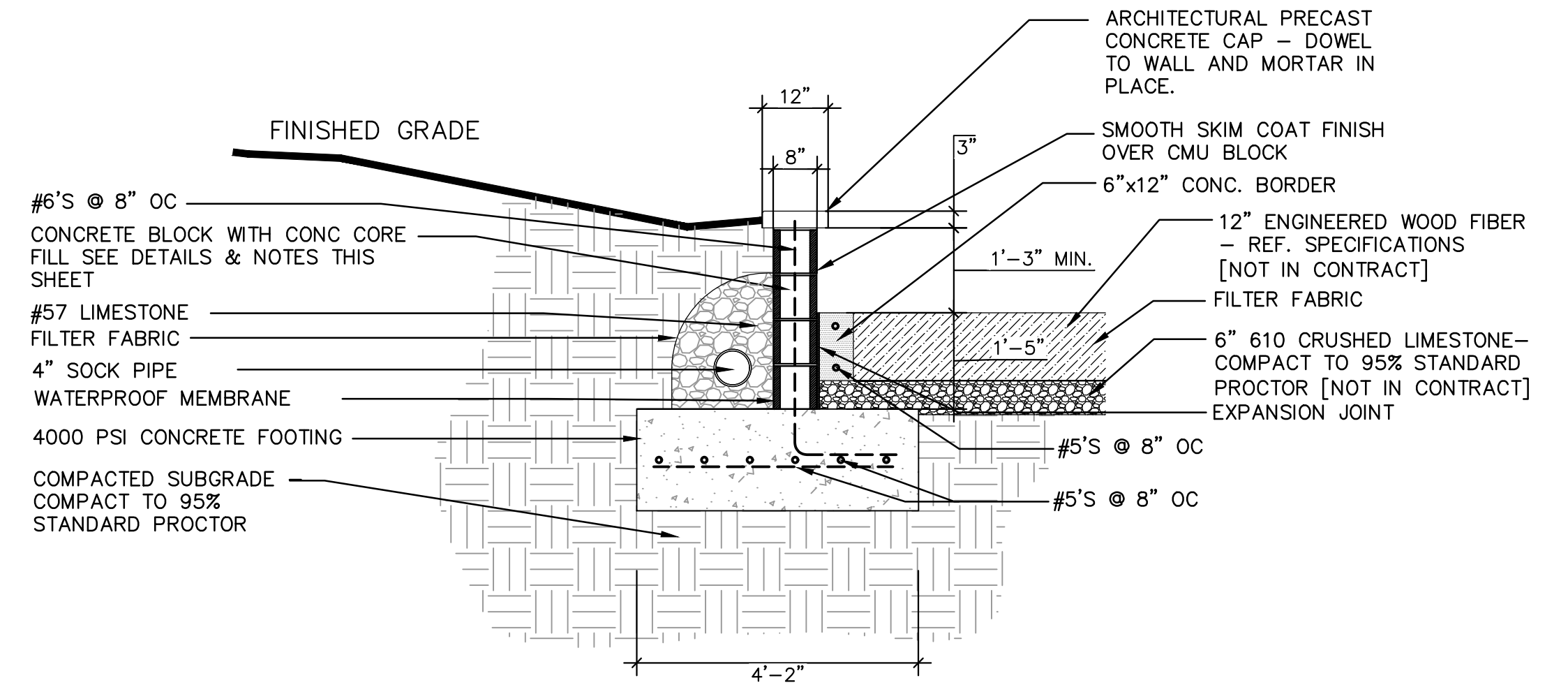

4. RETAINING WALL 'A' DETAIL
NOT TO SCALE

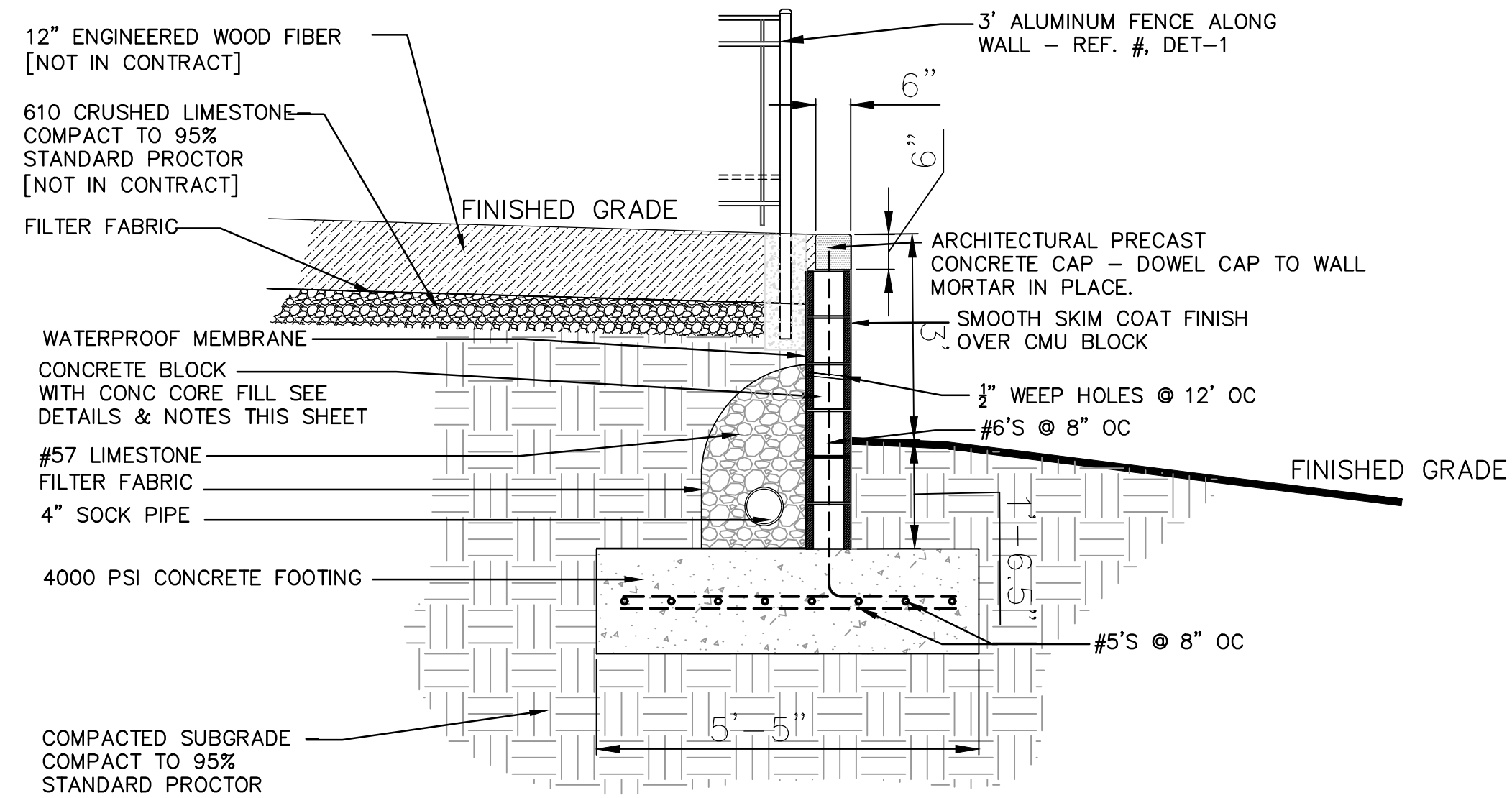

5. RETAINING WALL 'B' DETAIL
NOT TO SCALE

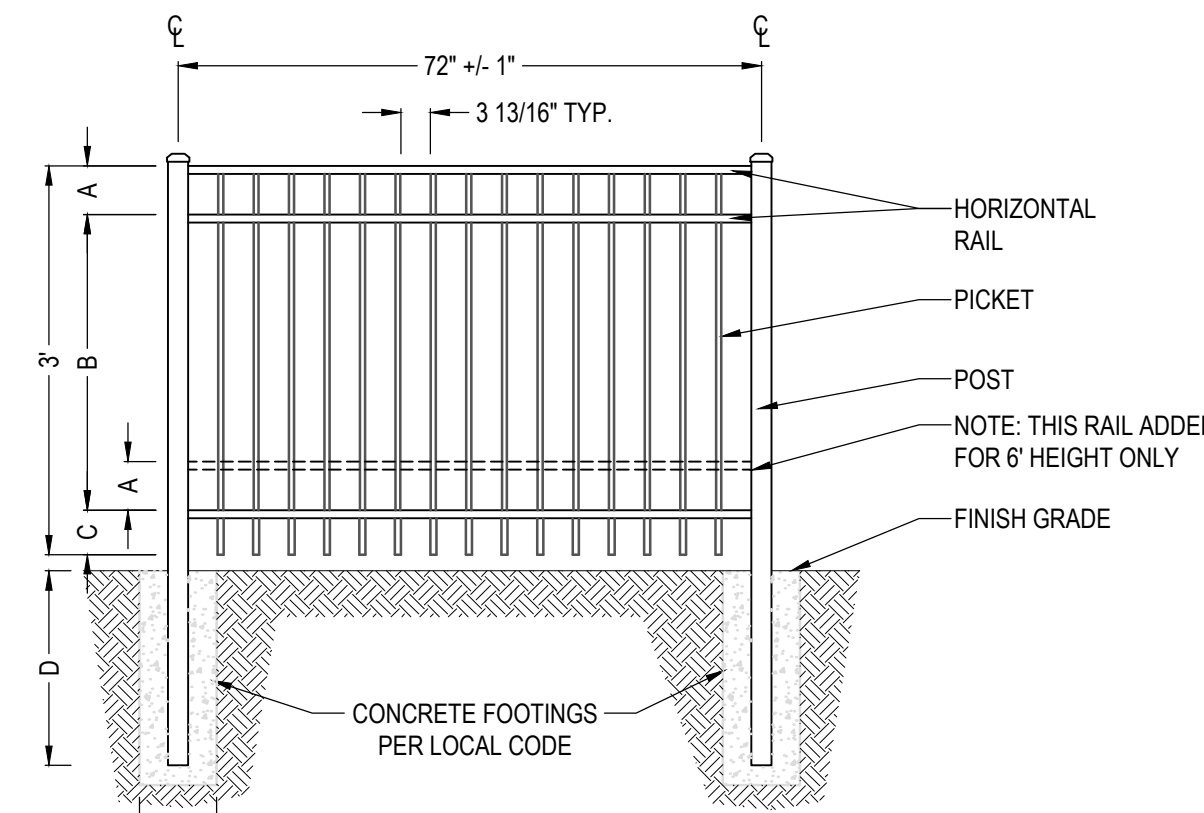

SPECIFICATIONS:

POSTS:

- 2" X 2" X .060" WALL
- 2" X 2" X .080" WALL
- 2" X 2" X .125" WALL
- 2 1/2" X 2 1/2" X .100" WALL

HORIZONTAL RAILS:

- 1 1/8" W X 1" H
- SIDE WALLS - .082"
- TOP WALLS - .062"
- 5/8" X 5/8" X .050" WALL
- PICKET SPACING - 3 13/16"

PICKETS:

NOTE: THIS RAIL ADDED FOR 6' HEIGHT ONLY

HEIGHT	DIMENSIONS				
	A	B	C	D	E
3'	6"	24 1/2"	5 1/2"	PER LOCAL CODE	
3 1/2'	6"	30 1/2"	5 1/2"	PER LOCAL CODE	
4'	6"	36 1/2"	5 1/2"	PER LOCAL CODE	
4 1/2'	6"	42 1/2"	5 1/2"	PER LOCAL CODE	
5'	6"	48 1/2"	5 1/2"	PER LOCAL CODE	
6'	6"	60 1/2"	5 1/2"	PER LOCAL CODE	

- NOTES:
- INSTALLATION TO BE COMPLETED IN ACCORDANCE WITH MANUFACTURER'S SPECIFICATIONS.
 - DO NOT SCALE DRAWING.
 - ALL INFORMATION CONTAINED HEREIN WAS CURRENT AT THE TIME OF DEVELOPMENT BUT MUST BE REVIEWED AND APPROVED BY THE PRODUCT MANUFACTURER TO BE CONSIDERED ACCURATE.
 - CONTRACTOR'S NOTE: FOR PRODUCT AND COMPANY INFORMATION VISIT www.CADdetails.com/info AND ENTER REFERENCE NUMBER 4855-102.

6. DECORATIVE ALUMINUM FENCE
NOT TO SCALE

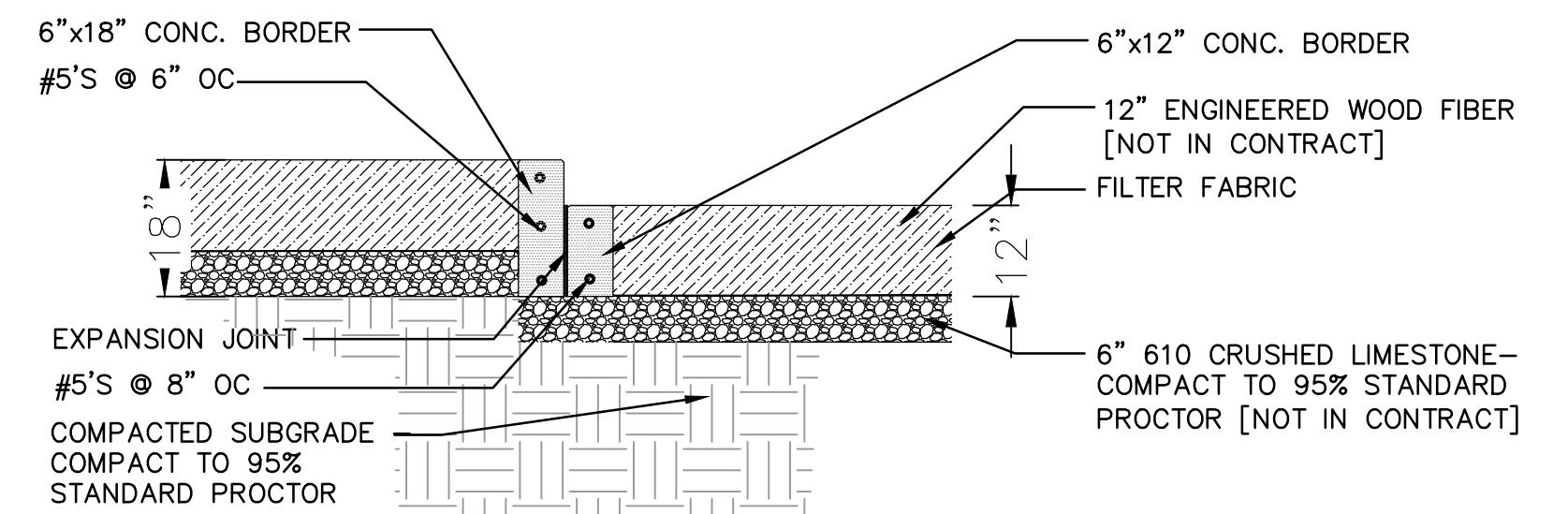

7. BORDER SECTION AT TODDLER AREA
NOT TO SCALE

NOTICE TO DRAWING HOLDER

NEEL-SCHAFFER, INC., HERINAFTER REFERRED TO AS THE ENGINEER HAS PREPARED AND FURNISHED THIS DRAWING TO THE OWNER FOR USE ON THIS PROJECT ONLY. THIS DRAWING SHOULD NOT BE USED ON EXTENSIONS OF THIS PROJECT OR ON ANY OTHER PROJECT. ANY REUSE OF THIS DRAWING, WITHOUT WRITTEN VERIFICATION OR ADAPTATION BY THE ENGINEER, SHALL BE AT THE REUSER'S SOLE RISK AND THE REUSER SHALL INDEMNIFY AND HOLD HARMLESS THE ENGINEER FROM ALL CLAIMS, DAMAGES, LOSSES AND EXPENSES, INCLUDING ATTORNEY'S FEES ARISING OUT OF OR RESULTING THEREFROM.

REVISIONS				DRAWING INFORMATION	
NO.	DATE	BY	DESCRIPTION	N-S PROJECT NO.:	FILENAME:
				NS.17293.001	17293_DETAILS.DWG
				SCALE: NOT TO SCALE	
				SURVEYED BY: BATSON & BROWN, INC.	
				DSGN: OOP DATE: 7/2023	
				DRWN: OOP DATE: 7/2023	
				CHKD: RPB DATE: 12/2023	
				QA/QC: KML DATE: 12/2023	

CITY PARK PLAYGROUND
SITE WORK

CITY OF LUCEDALE
GEORGE COUNTY, MISSISSIPPI

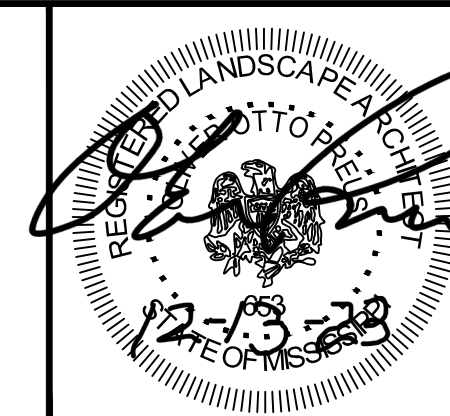

TYPICAL DETAILS	
WORKING NUMBER:	DRAWING NUMBER:
DET-1	8

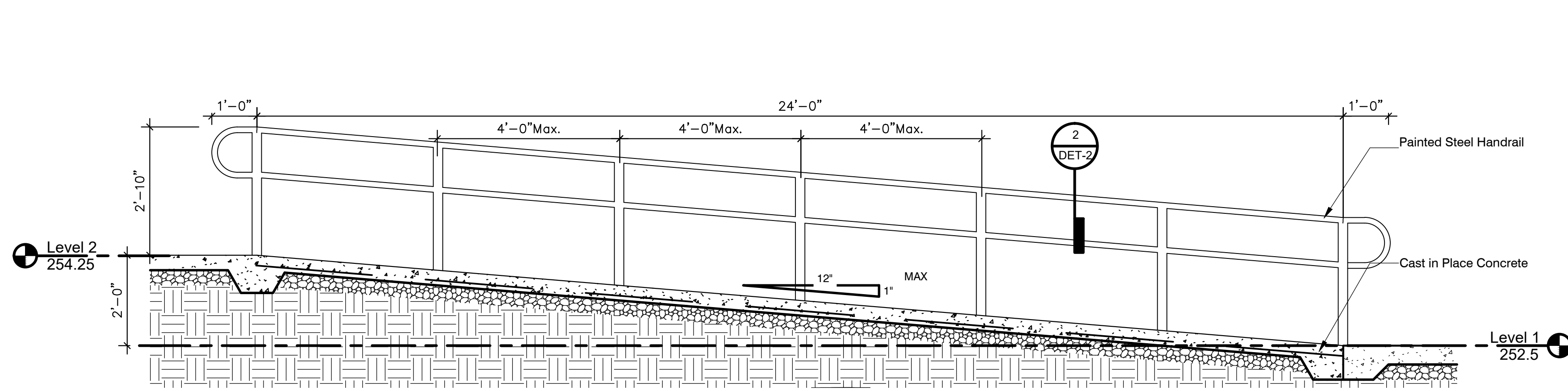

1. ADA RAMP DETAIL 'A'
NOT TO SCALE

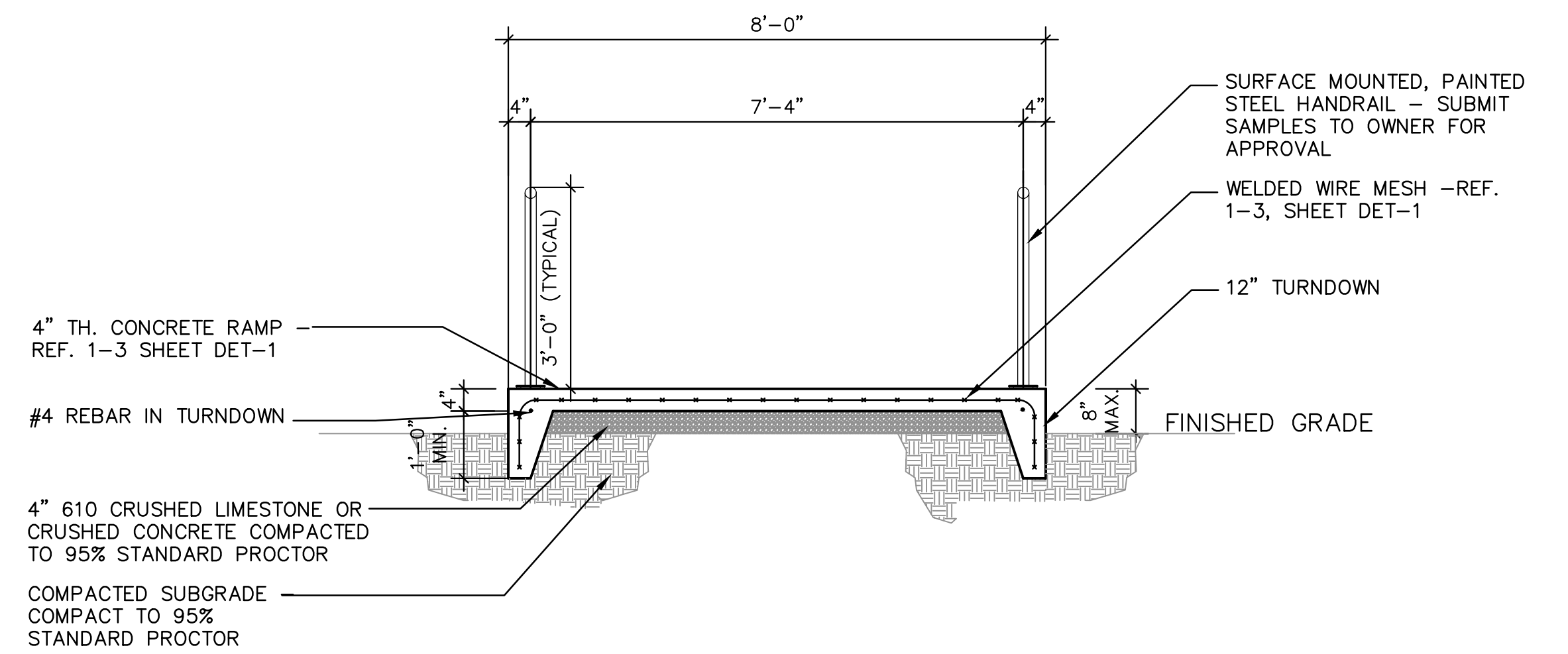

2. ADA RAMP DETAIL 'B'
NOT TO SCALE

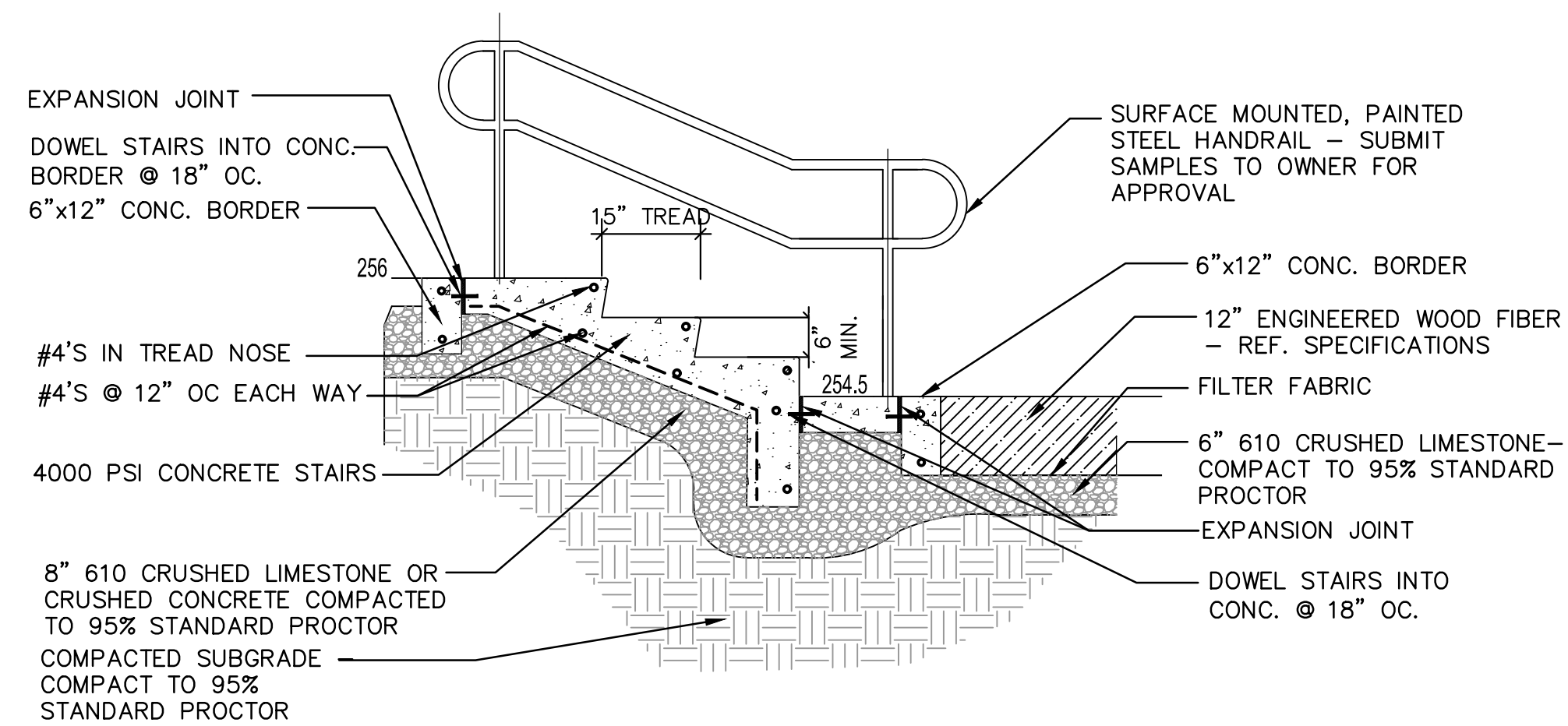

3. CONCRETE STAIR DETAIL 'A'
NOT TO SCALE

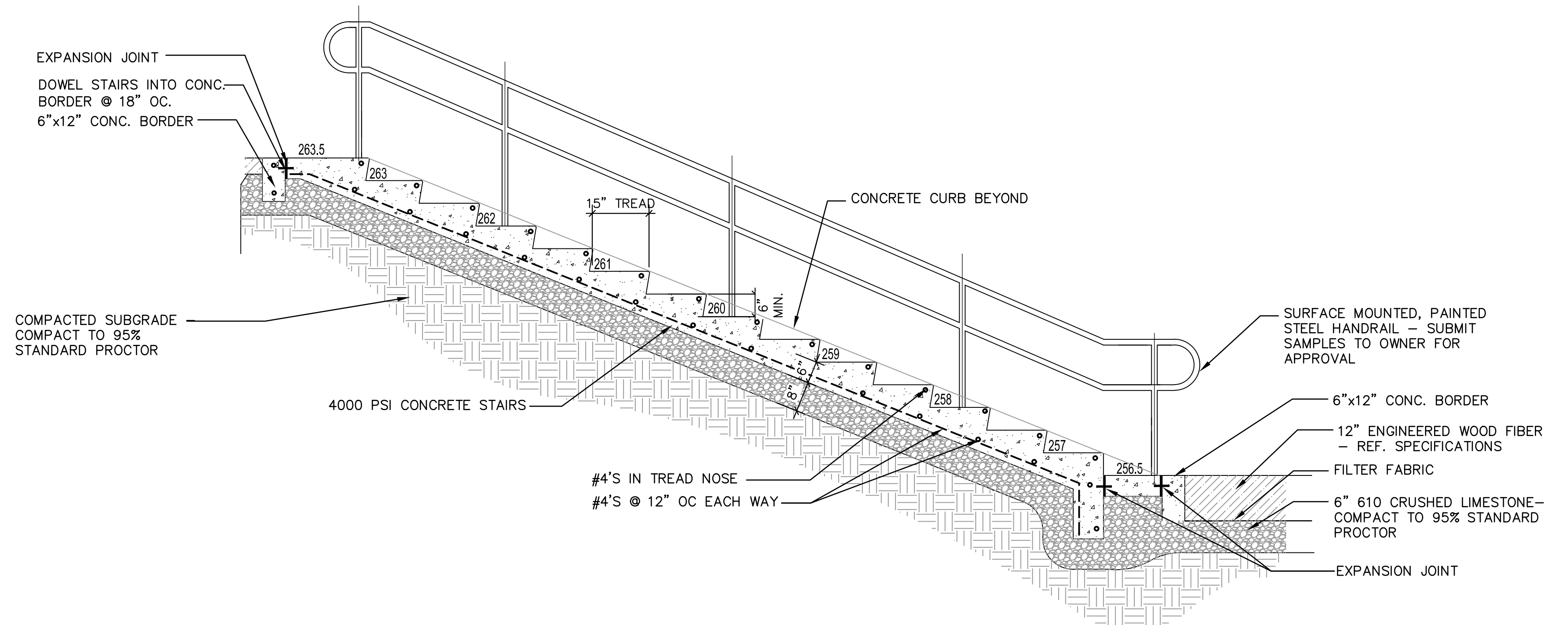

4. CONCRETE STAIR DETAIL 'B'
NOT TO SCALE

NOTICE TO DRAWING HOLDER

NEEL-SCHAFFER, INC., HEREINAFTER REFERRED TO AS THE ENGINEER HAS PREPARED AND FURNISHED THIS DRAWING TO THE OWNER FOR USE ON THIS PROJECT ONLY. THIS DRAWING SHOULD NOT BE USED ON EXTENSIONS OF THIS PROJECT OR ON ANY OTHER PROJECT. ANY REUSE OF THIS DRAWING, WITHOUT WRITTEN VERIFICATION OR ADAPTATION BY THE ENGINEER, SHALL BE AT THE REUSER'S SOLE RISK AND THE REUSER SHALL INDEMNIFY AND HOLD HARMLESS THE ENGINEER FROM ALL CLAIMS, DAMAGES, LOSSES AND EXPENSES, INCLUDING ATTORNEY'S FEES ARISING OUT OF OR RESULTING THEREFROM.

REVISIONS			DRAWING INFORMATION
NO.	DATE	BY	DESCRIPTION

N-S PROJECT NO.:	NS.17293.001
FILENAME:	17293_DETAILS.DWG
SCALE:	NOT TO SCALE
SURVEYED BY:	BATSON & BROWN, INC.
DSGN:	OOP DATE: 7/2023
DRWN:	OOP DATE: 7/2023
CHKD:	RPB DATE: 12/2023
QA/QC:	KML DATE: 12/2023

CITY PARK PLAYGROUND
SITE WORK

CITY OF LUCEDALE
GEORGE COUNTY, MISSISSIPPI

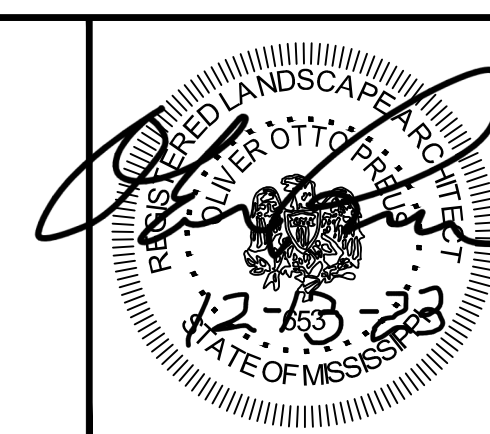

TYPICAL DETAILS

WORKING NUMBER:

DET-2

DRAWING NUMBER:

9

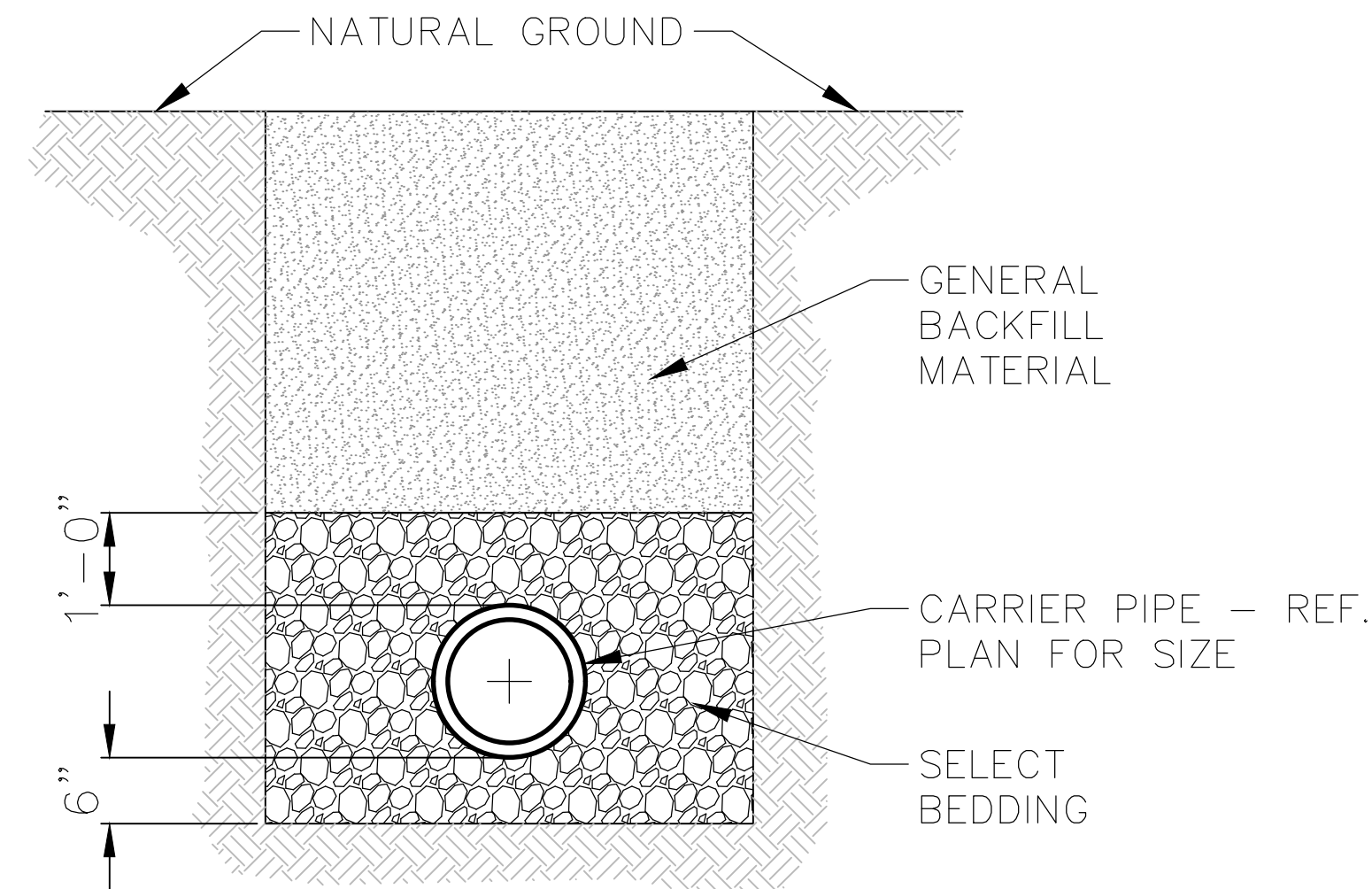

TYPICAL TRENCH DETAIL OUTSIDE PAVEMENT
NOT TO SCALE

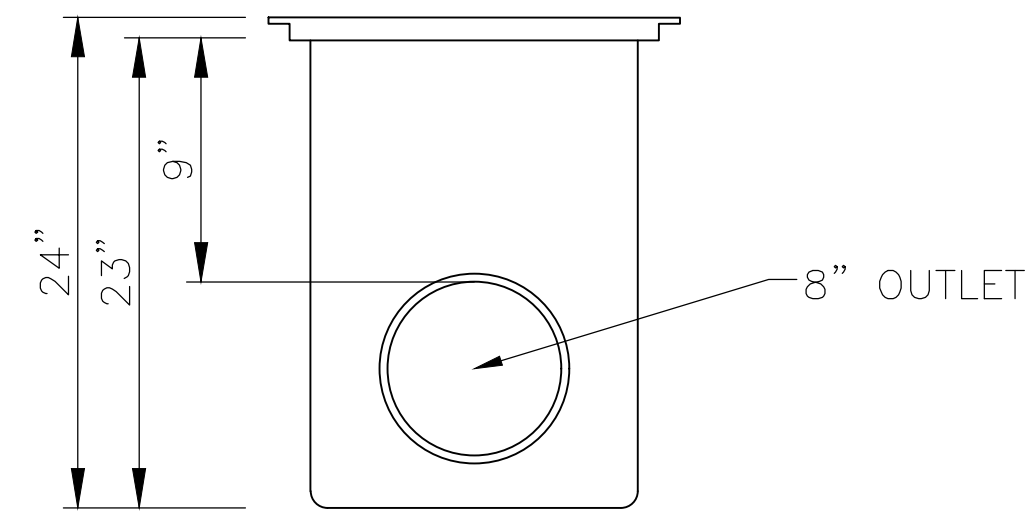

DRAIN INLET SECTION DETAIL
N.T.S.

SCHEDULE OF PIPE BEDDING WIDTHS

PIPE SIZE "D" (IN.)	MINIMUM TRENCH WIDTH "B" (FT. & IN.)	MINIMUM TRENCH WIDTH (FT. & IN.)
4	1'-10"	3'-0"
6	2'-0"	3'-6"
8	2'-2"	3'-6"
10	2'-4"	4'-0"
12	2'-6"	4'-0"
15	3'-0"	4'-0"
18	3'-0"	4'-0"

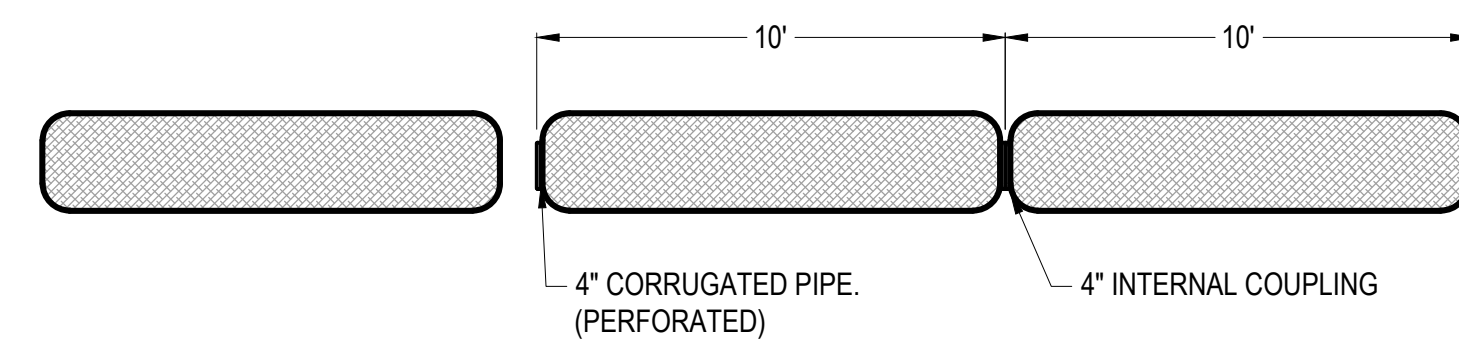
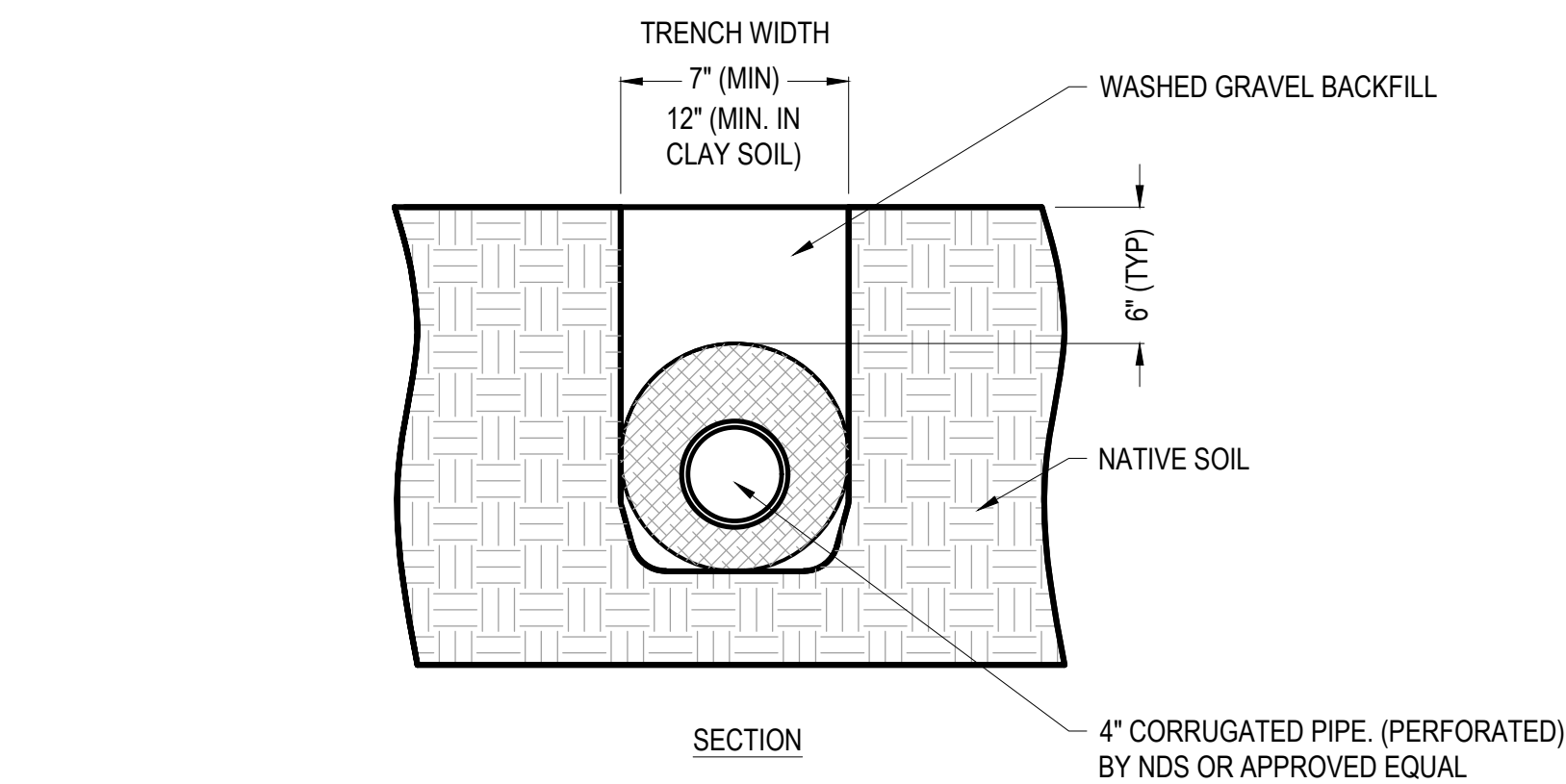

ADDITIONAL COVER MAY BE REQUIRED BASED ON SITE CONDITIONS. 12" COVER REQUIRED TO OBTAIN AN H-10 LOAD RATING. CONSULT WITH A LOCAL ENGINEER FOR SITE SPECIFIC REQUIREMENTS.

MANUFACTURER NOTES:

- FOR PRODUCT ASSISTANCE, CONTACT NDS TECHNICAL SERVICE AT TECHSERVICE@NDSPRO.COM.

NOTES:

- INSTALLATION TO BE COMPLETED IN ACCORDANCE WITH MANUFACTURER'S SPECIFICATIONS.
- DO NOT SCALE DRAWING.
- ALL INFORMATION CONTAINED HEREIN WAS CURRENT AT THE TIME OF DEVELOPMENT BUT MUST BE REVIEWED AND APPROVED BY THE PRODUCT MANUFACTURER TO BE CONSIDERED ACCURATE.
- CONTRACTOR'S NOTE: FOR PRODUCT AND COMPANY INFORMATION VISIT www.CADdetails.com/info AND ENTER REFERENCE NUMBER

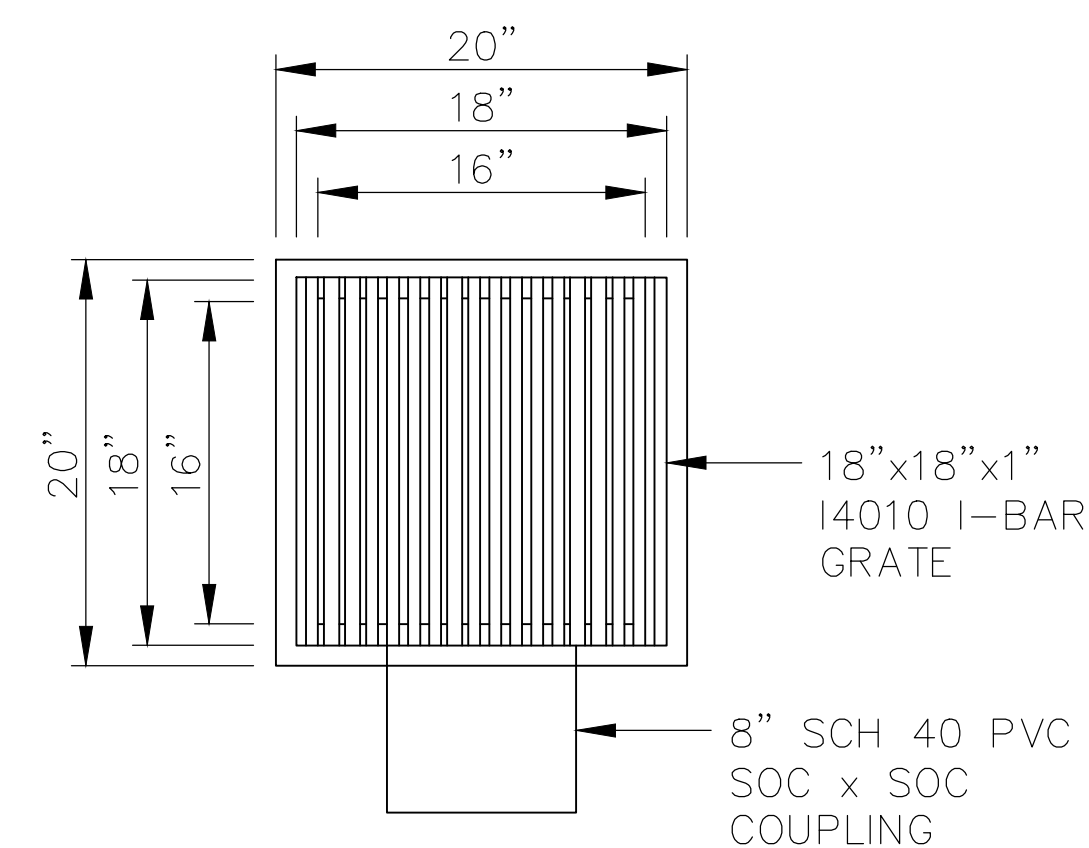

NOTICE TO DRAWING HOLDER

NEEL-SCHAFFER, INC., HERINAFTER REFERRED TO AS THE ENGINEER HAS PREPARED AND FURNISHED THIS DRAWING TO THE OWNER FOR USE ON THIS PROJECT ONLY. THIS DRAWING SHOULD NOT BE USED ON EXTENSIONS OF THIS PROJECT OR ON ANY OTHER PROJECT. ANY REUSE OF THIS DRAWING, WITHOUT WRITTEN VERIFICATION OR ADAPTATION BY THE ENGINEER, SHALL BE AT THE REUSER'S SOLE RISK AND THE REUSER SHALL INDEMNIFY AND HOLD HARMLESS THE ENGINEER FROM ALL CLAIMS, DAMAGES, LOSSES AND EXPENSES, INCLUDING ATTORNEY'S FEES ARISING OUT OF OR RESULTING THEREFROM.

REVISIONS				DRAWING INFORMATION	
NO.	DATE	BY	DESCRIPTION		
				N-S PROJECT NO.: NS.17293.001	
				FILENAME: 17293_DETAILS.DWG	
				SCALE: NOT TO SCALE	
				SURVEYED BY: BATSON & BROWN, INC.	
				DSGN: OOP DATE: 7/2023	
				DRWN: OOP DATE: 7/2023	
				CHKD: RPB DATE: 12/2023	
				QA/QC: KML DATE: 12/2023	

**CITY PARK PLAYGROUND
SITE WORK**

CITY OF LUCEDALE
GEORGE COUNTY, MISSISSIPPI

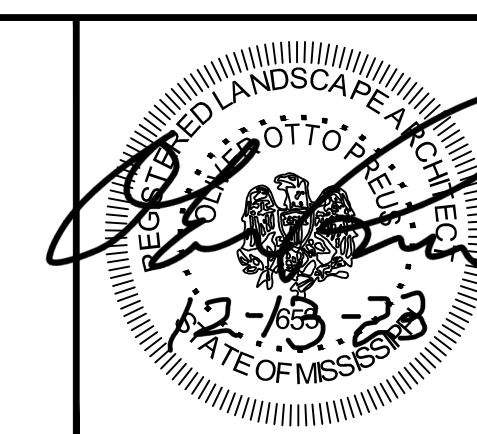

DRAINAGE DETAILS

WORKING NUMBER: DET-3	DRAWING NUMBER: 10
---------------------------------	------------------------------

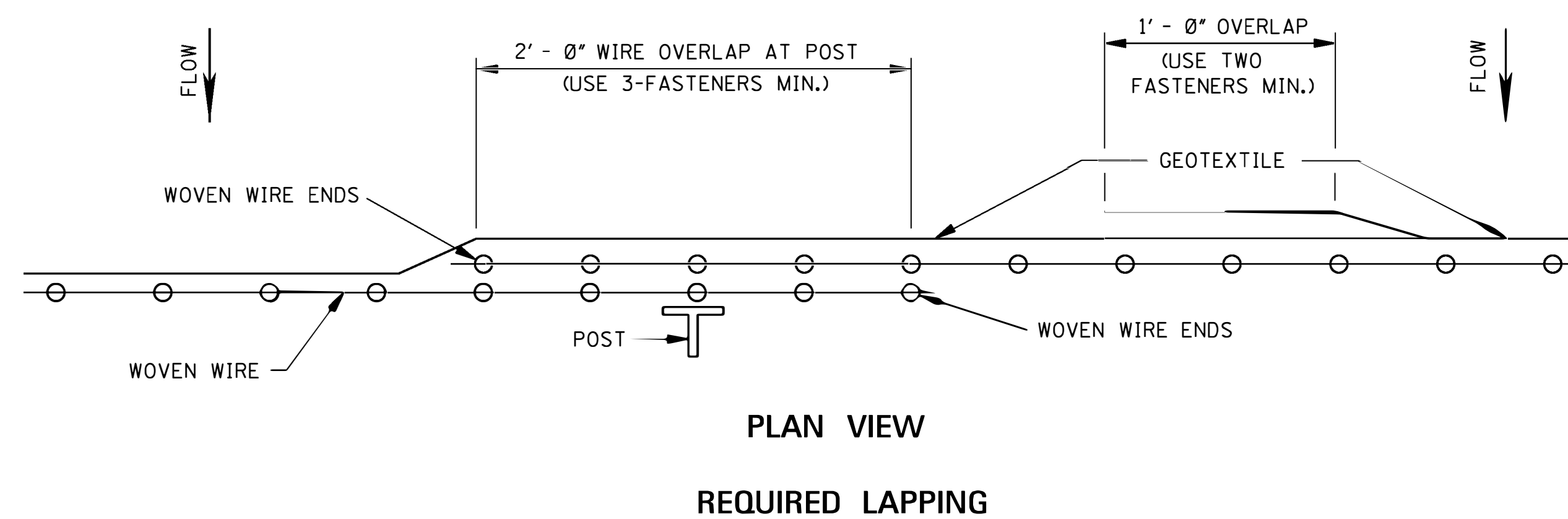
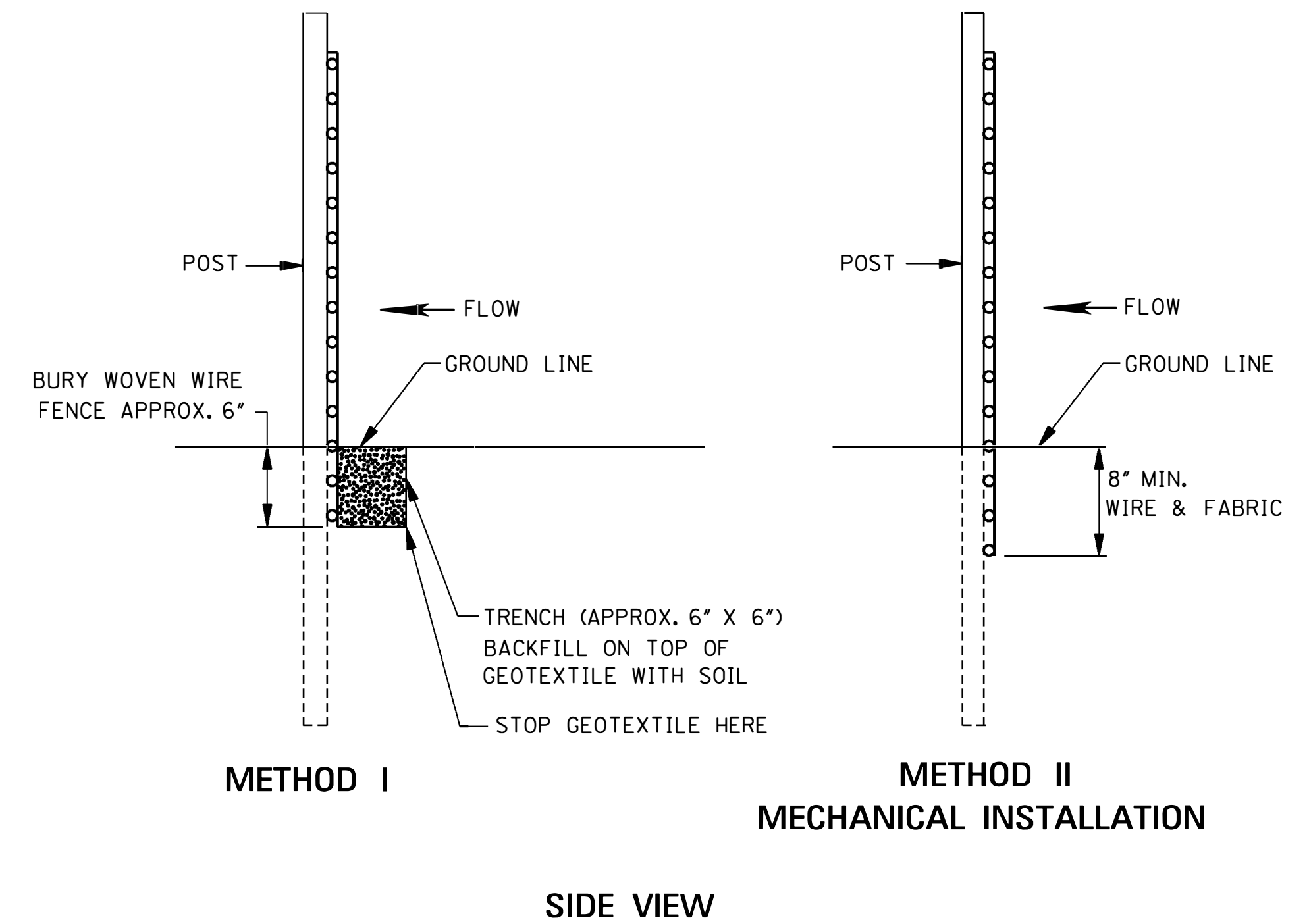
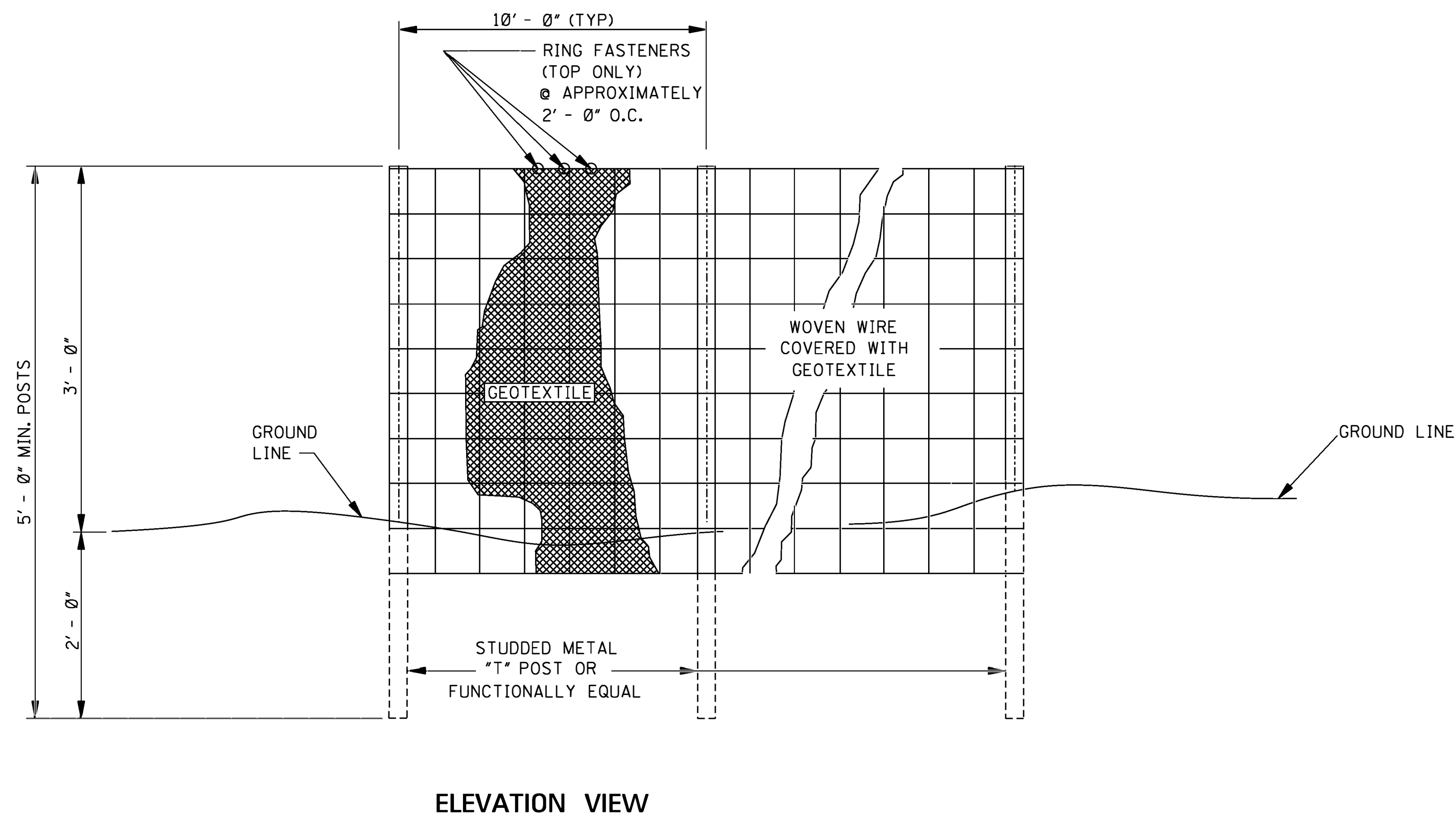

GENERAL NOTES:

- SILT FENCES SHOULD BE USED IN AREAS WHERE FLOW IS NOT SEVERE.
- SILT FENCES ARE TEMPORARY SEDIMENT CONTROL ITEMS THAT SHOULD BE ERECTED OPPOSITE ERODIBLE AREAS SUCH AS NEWLY GRADED FILL SLOPES AND ADJACENT TO STEAMS AND CHANNELS.
- SILT FENCE SHOULD BE PLACED WELL INSIDE RIGHT-OF-WAY AND ALONG EDGE OF CLEARING LIMITS. THIS WILL ALLOW ROOM FOR BACK-UP FENCE IF FIRST FENCE BECOMES FULL.
- WHENEVER POSSIBLE SILT FENCE SHOULD BE CONSTRUCTED ACROSS A LEVEL AREA IN THE SHAPE OF A SMILE. THIS AIDS IN PONDING OF RUNOFF AN FACILITATES SEDIMENTATION.
- THE CONTRACTOR MAY ELECT TO USE EITHER METHOD I OR METHOD II. COST TO BE LINEAR FEET OF SILT FENCE.
- METHOD II INSTALLATION SHALL BE ACCOMPLISHED USING AN IMPLEMENT THAT IS MANUFACTURED FOR THE APPLICATION AND PROVIDES A CONFIGURATION MEETING THE REQUIREMENTS OF DETAIL.
- WIRE SHALL BE A MINIMUM OF 32" IN WIDTH AND SHALL HAVE A MINIMUM OF 6 LINE WIRES WITH 12" STAY SPACING.
- GEOTEXTILE FABRIC MEETING THE TYPE II MATERIAL REQUIREMENTS AND INSTALLED ACCORDING TO SPECIFICATION MAY BE USED WITHOUT WIRE FENCE.

MISSISSIPPI DEPARTMENT OF TRANSPORTATION ROADWAY DESIGN DIVISION STANDARD PLAN	
DETAILS OF SILT FENCE INSTALLATION	
BY	
REVISION	
DATE	ISSUE DATE: AUGUST 01, 2017
WORKING NUMBER	ECD-3
SHEET NUMBER	6103

NOTE: SILT FENCE OR SANDBAGS MAY ALSO BE USED FOR THIS APPLICATION.
HAY BALES NOT ACCEPTABLE DURING THIS STAGE.

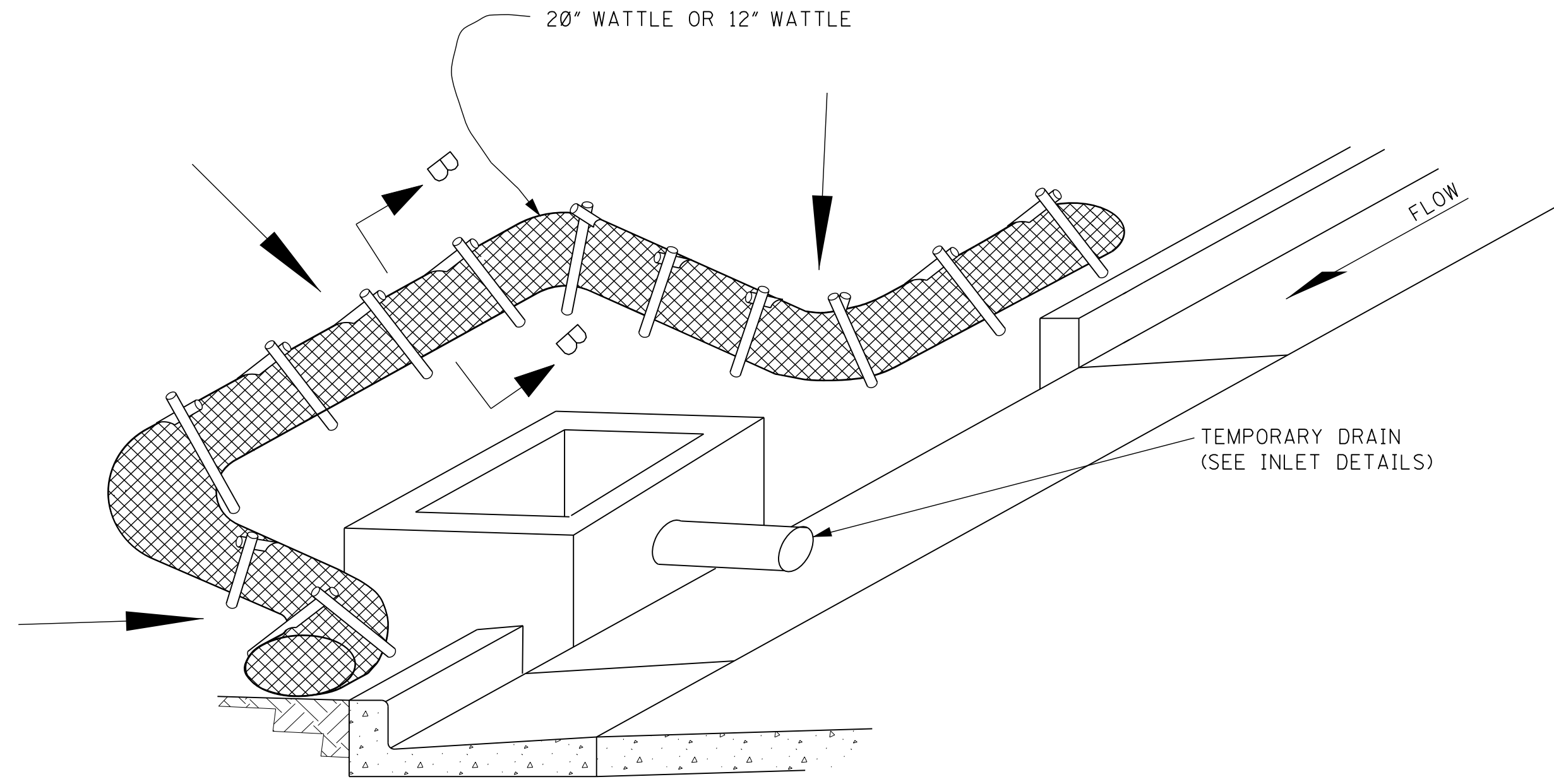

CURB INLET PROTECTION (STAGE 2)
SINGLE OR DOUBLE WING INLET

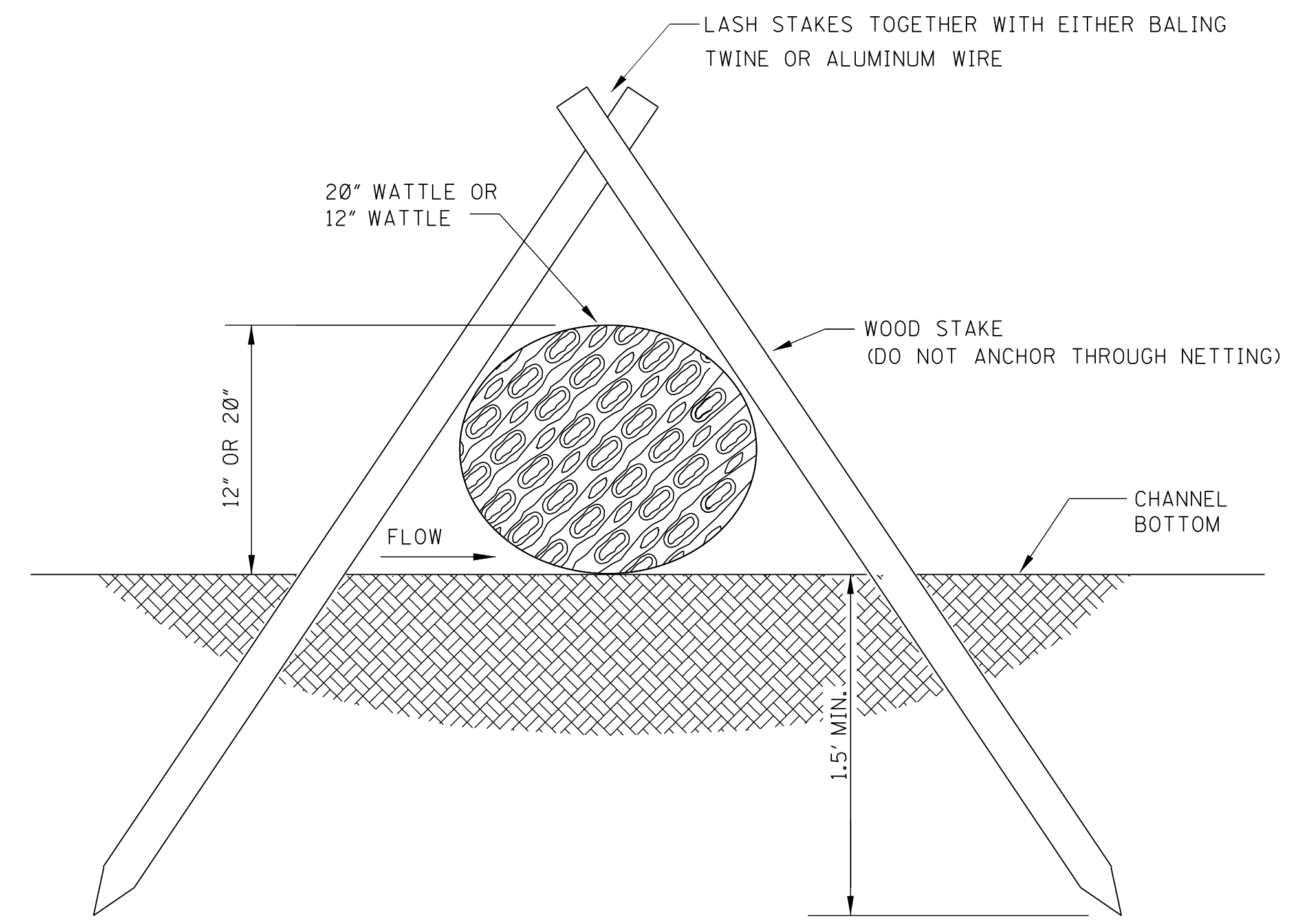

SECTION B-B

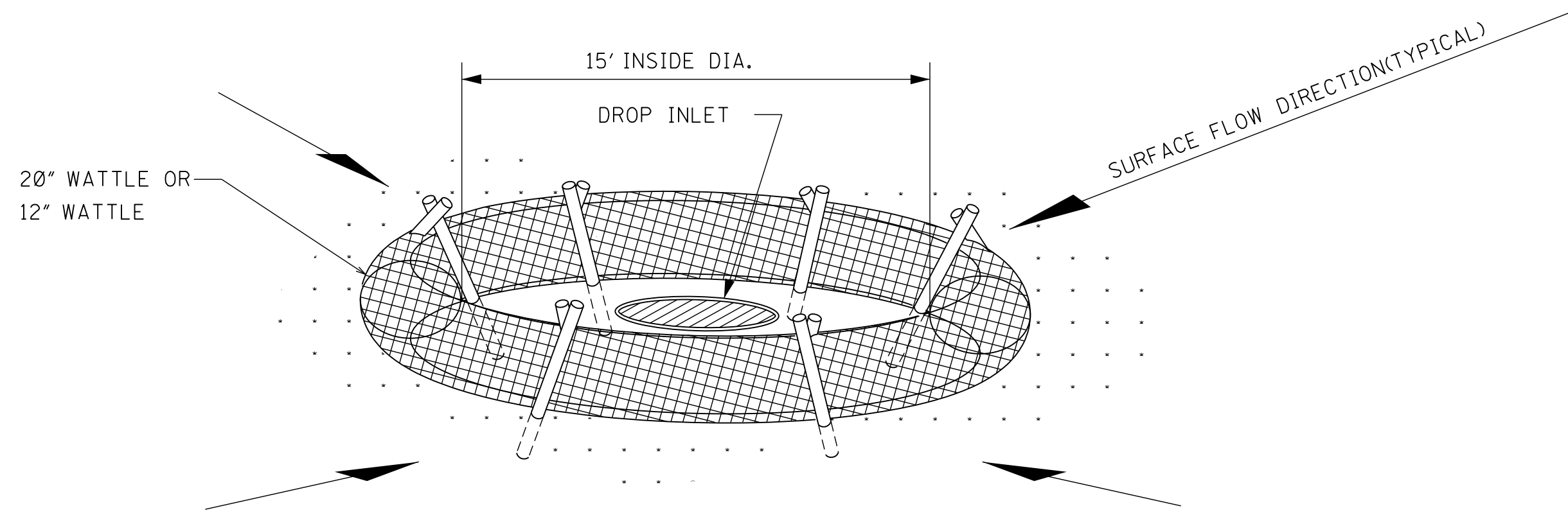

DROP INLET PROTECTION

- NOTES:
- ANCHORING STAKES SHALL BE SIZED, SPACED, AND BE OF A MATERIAL THAT EFFECTIVELY SECURES THE WATTLE. STAKE SPACING SHALL BE A MAXIMUM OF THREE FEET.
 - OVERLAP ENDS OF WATTLES PER MANUFACTURER'S RECOMMENDATIONS (1' MIN., 3' MAX.)
 - TRENCHING OF WATTLES MAY BE NECESSARY IF PIPING BECOMES EVIDENT.
 - IN THE EVENT WATTLES CANNOT BE SECURED IN PLACE USING WOOD STAKES, SANDBAGS MAY BE USED IN LIEU OF WOOD STAKES IN ORDER TO SECURE WATTLES IN PLACE. COST OF SANDBAGS USED IN THIS APPLICATION SHALL BE INCLUDED IN OTHER ITEMS BID.

BY		MISSISSIPPI DEPARTMENT OF TRANSPORTATION ROADWAY DESIGN DIVISION STANDARD PLAN	
REVISION		<p align="center">INLET PROTECTION DETAILS OF WATTLES</p> 	
DATE			
ISSUE DATE:		AUGUST 01, 2017	
WORKING NUMBER		ECD-13	
SHEET NUMBER		6113	